



Palou Avenue Streetscape Improvement Project

Barneveld Avenue to Crisp Road

Streetscape project update and Jennings Plaza Discussion

Community Meeting #5

July 27, 2016



SAFETY
IN ACTION

Agenda

- Welcome and introductions 5 minutes
- Project overview, history, goals, and update on final design 20 minutes
- Jennings Plaza update 35 minutes
- Questions and answers 15 minutes

Project Team

SAN FRANCISCO PUBLIC WORKS

Oscar Gee, Project Manager

Marci Camacho, Project Management Assistant

Bo Sousa, Streets and Highways

Bill Bulkley, Landscape Architect

Julian Pham, Public Affairs

MUNICIPAL TRANSPORTATION AGENCY

Felipe Robles, Transportation Planner



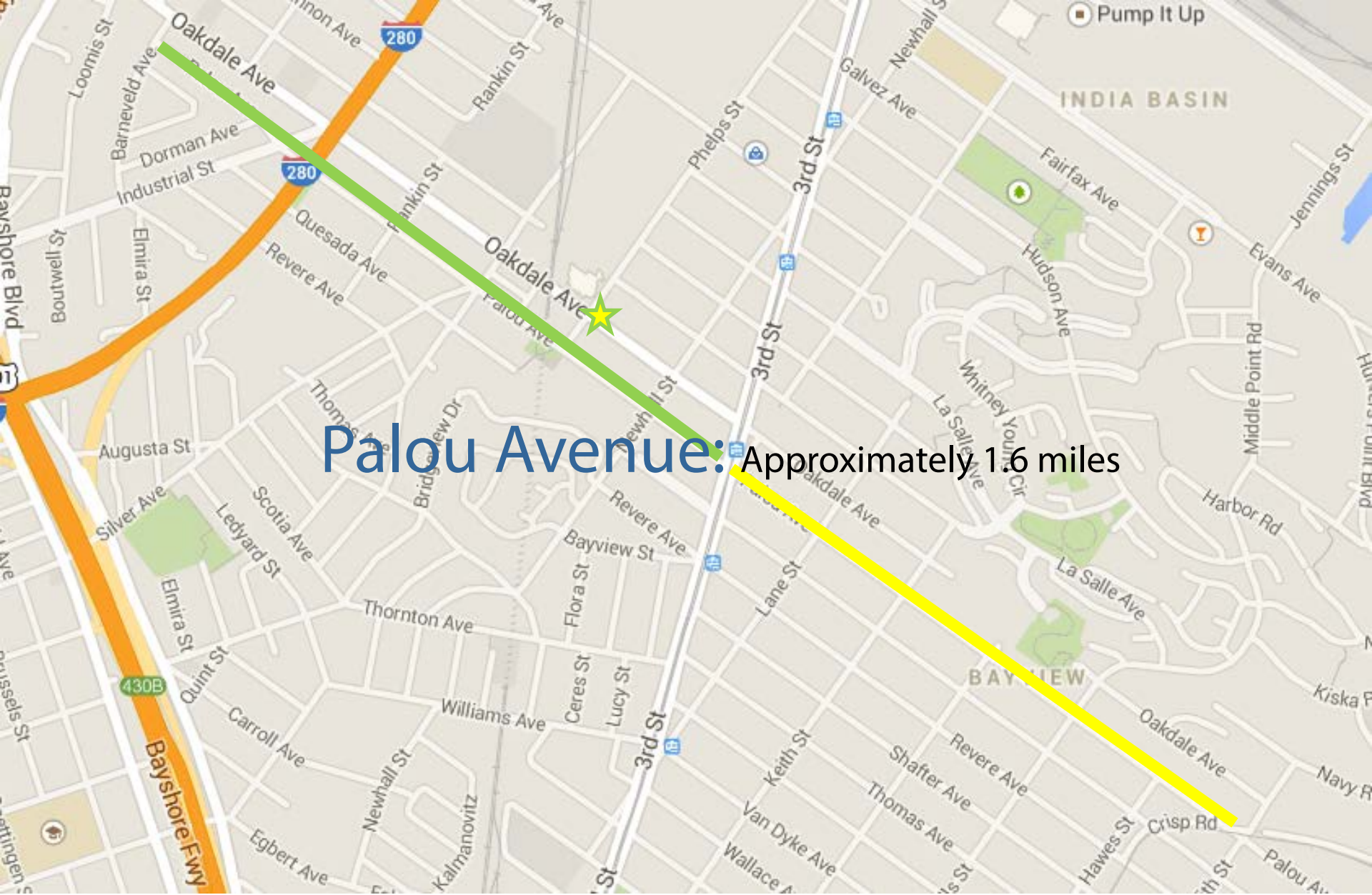

Palou Avenue: Approximately 1.6 miles



SAFETY IN ACTION

Schedule

September 2013 – June 2015

July 2015 – September 2016

October 2016 – February 2017

March 2017 – February 2018

planning phase

design phase

bid/ award

construction

Overall Project Budget: Approximately \$10 million contributed by the following programs:

Streetscape program (2011 Prop B funds)

Paving program

Sewer program

Jennings Plaza Grant: **\$450,000**

SFMTA-Oakdale / Phelps bulb-outs

Vision Zero SF program



Improve pedestrian safety



Provide traffic calming



Greening

Project Goals

Review pedestrian safety, traffic calming, greening, and improved traffic times project goals with guiding policies from:

- Better Streets Plan
- Complete Streets Policy
- Bicycle Plan
- Vision Zero SF
- Muni Forward
- Green Connections
- Candlestick & Hunters Point Shipyard long-term plan

Key plan for intersection concepts

Sewer work not shown on Key Plan:

- Side sewer lateral replacement between Jennings and Ingalls
- Main sewer repair: between Ingalls and Hawes

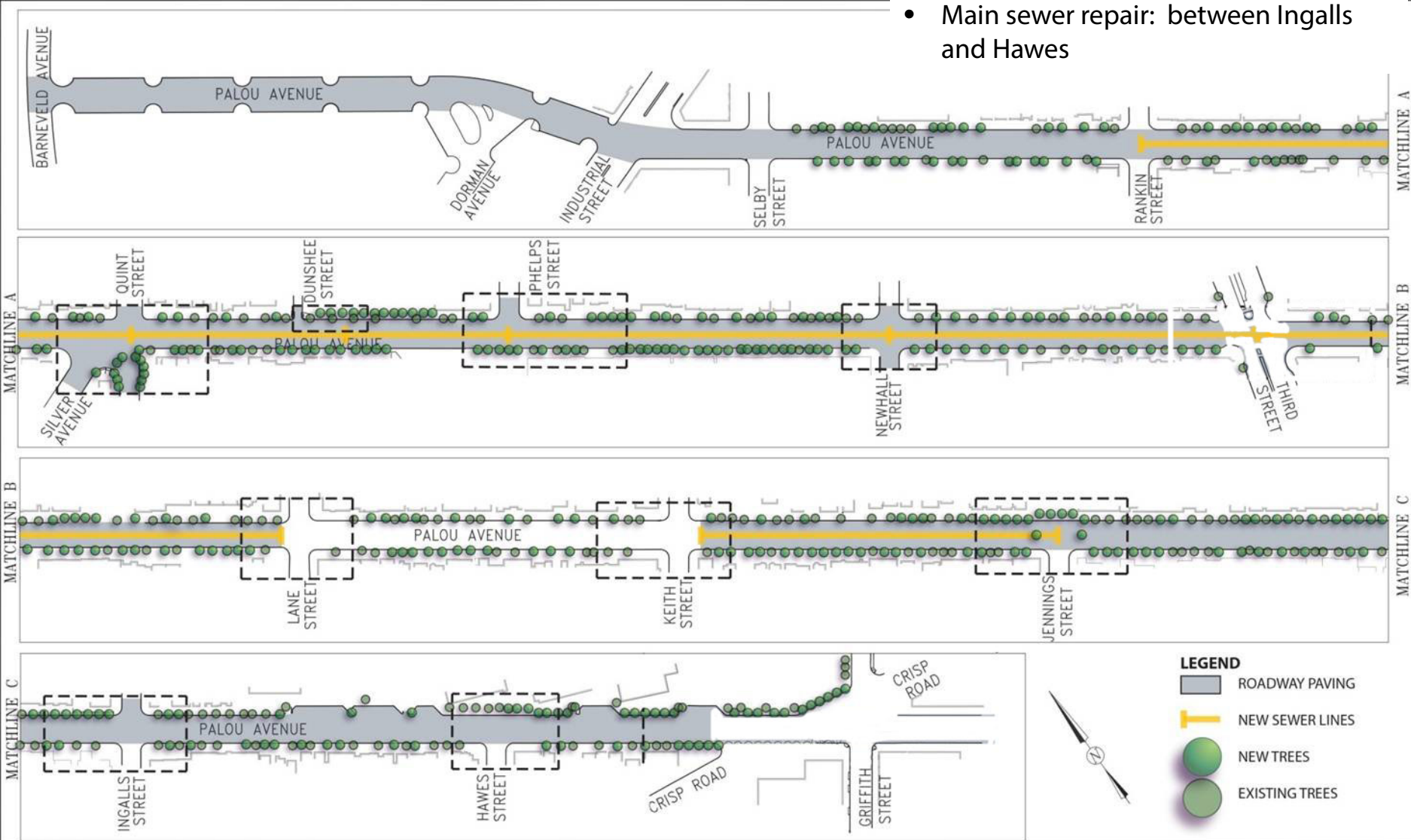

SAFETY IN ACTION

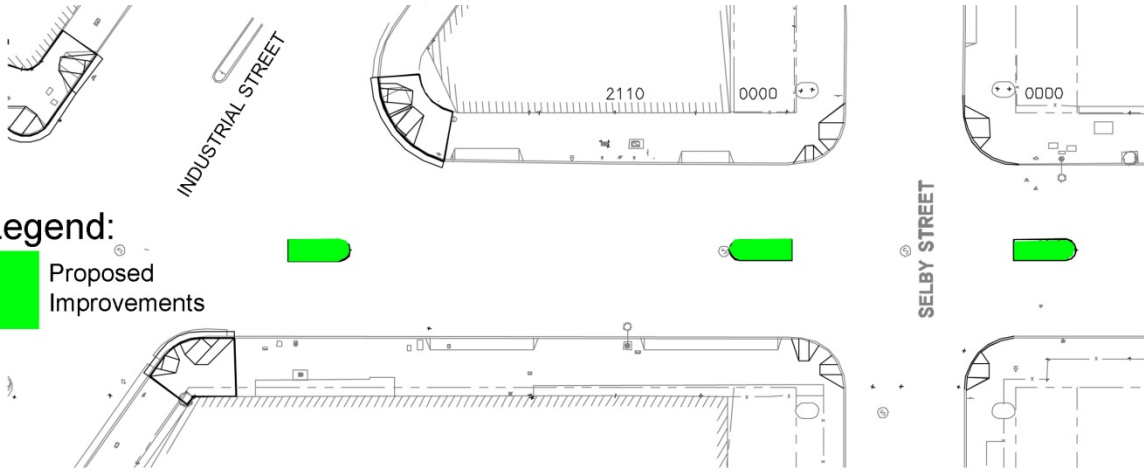

Industrial and Selby streets

- No change:
- median islands

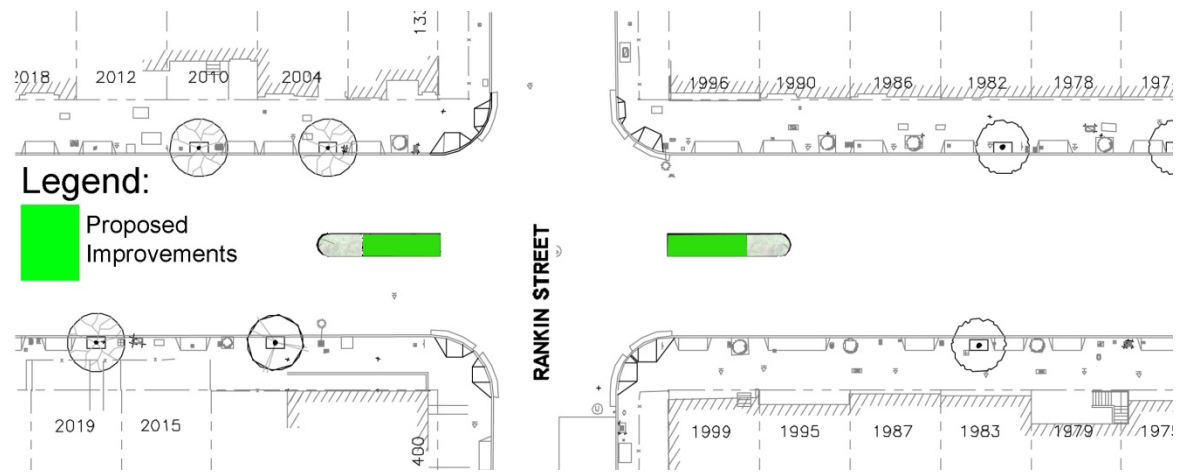

Rankin Street

- No change:
- planted median islands

Quint to Silver

Recent plan

- Cul-de-sac
- add median island

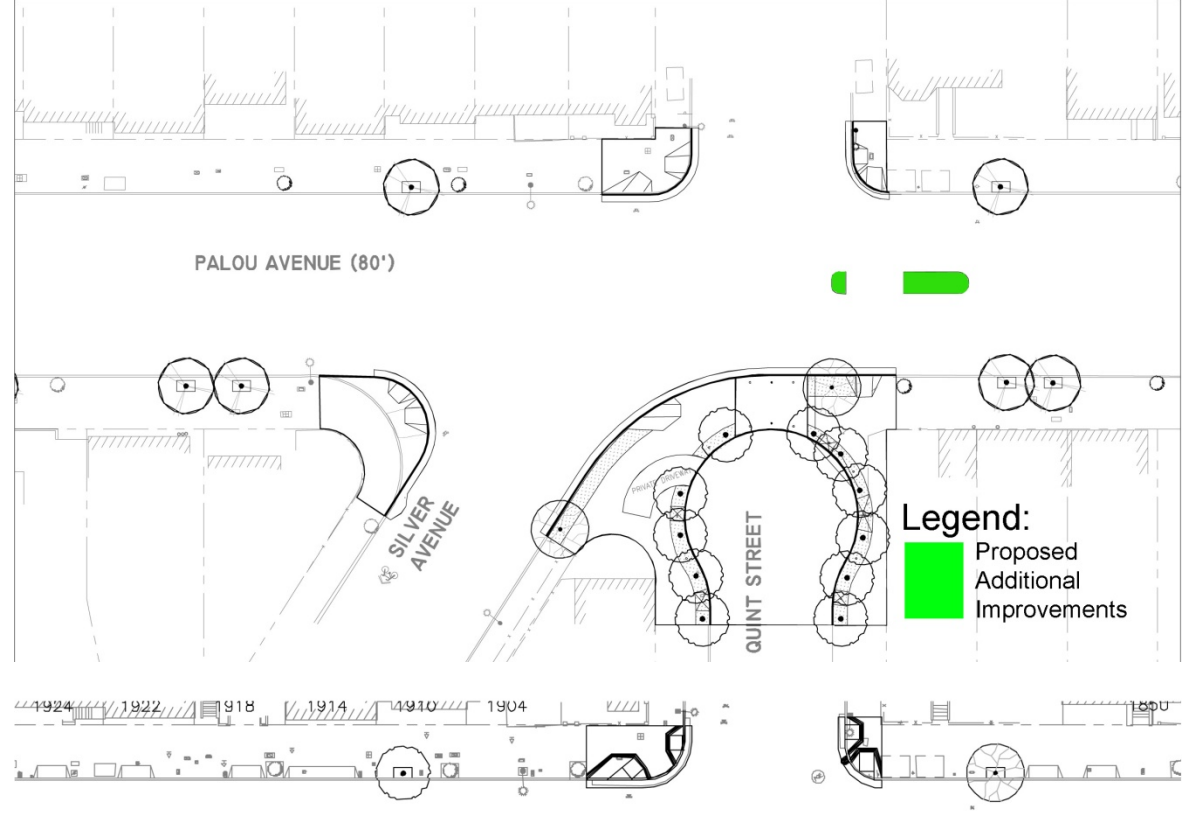

Palou Avenue

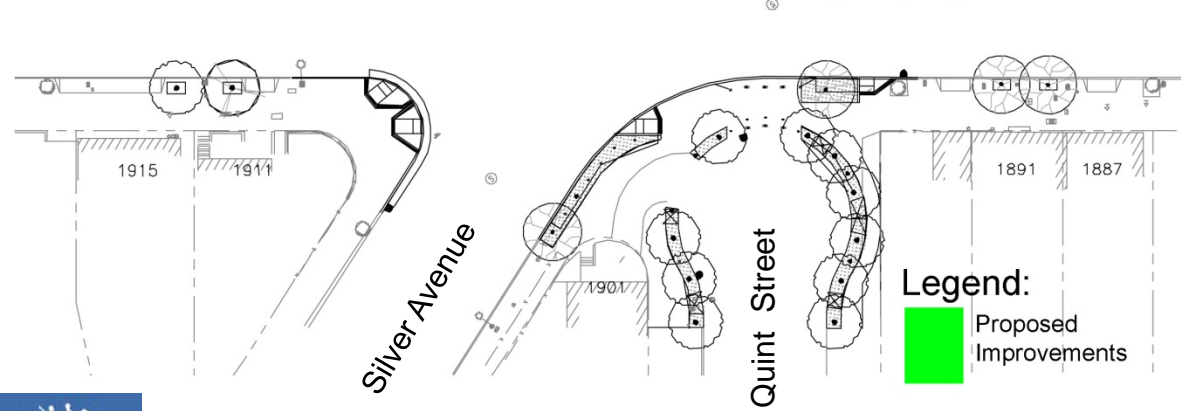

No change:

- Cul-de-sac
- median island



Phelps Street

Recent plan

- bulb-out
- planted median island

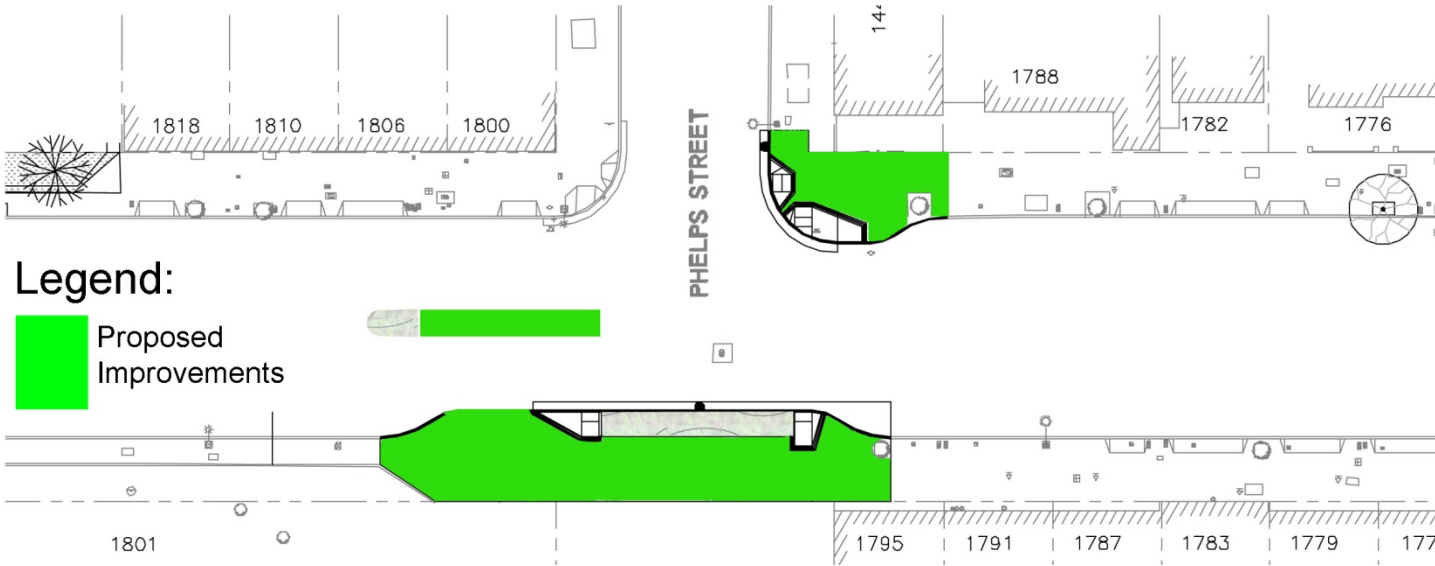

Legend:

- Proposed Improvements

Proposed:

- Removed 1 bulb-out
- planted median island
- Shorter bus bulb
- Shorter ped bulb
- Planting area at bus bulb

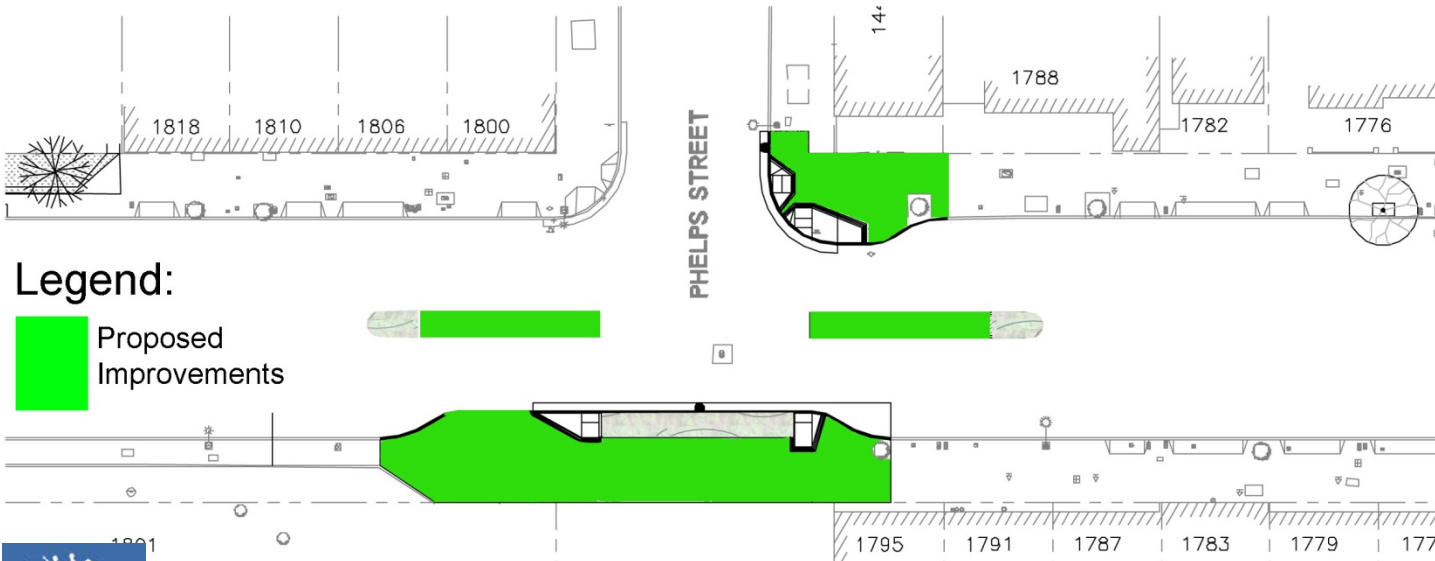

Oakdale and Phelps Streets

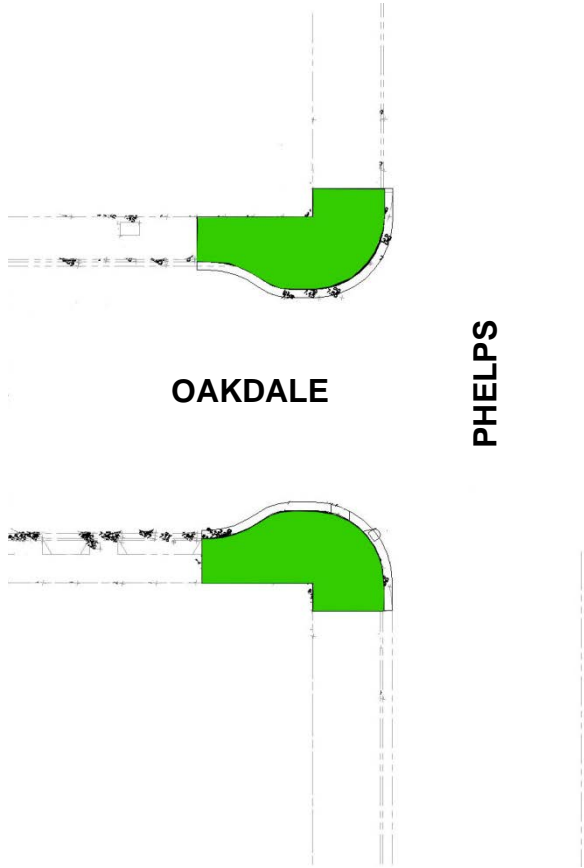

Recent:
•No change

Dunshee Street

No change:

- Raised crosswalk
- Planted area

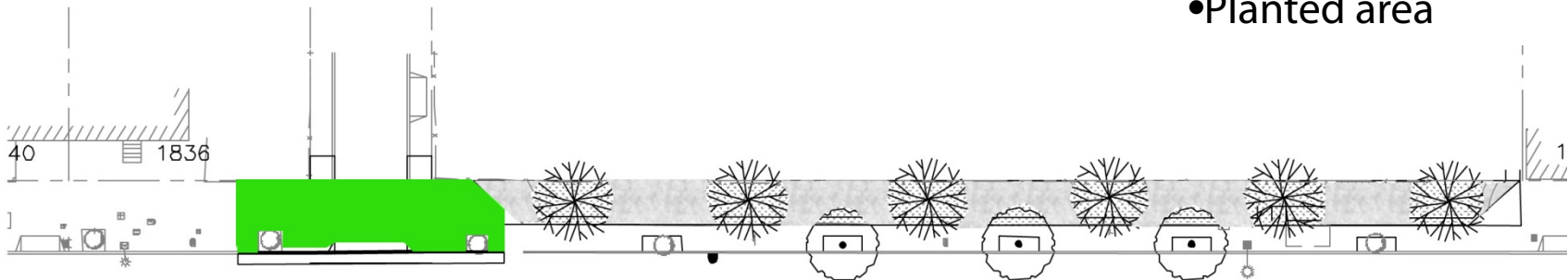

⊙ PALOU AVENUE (80')

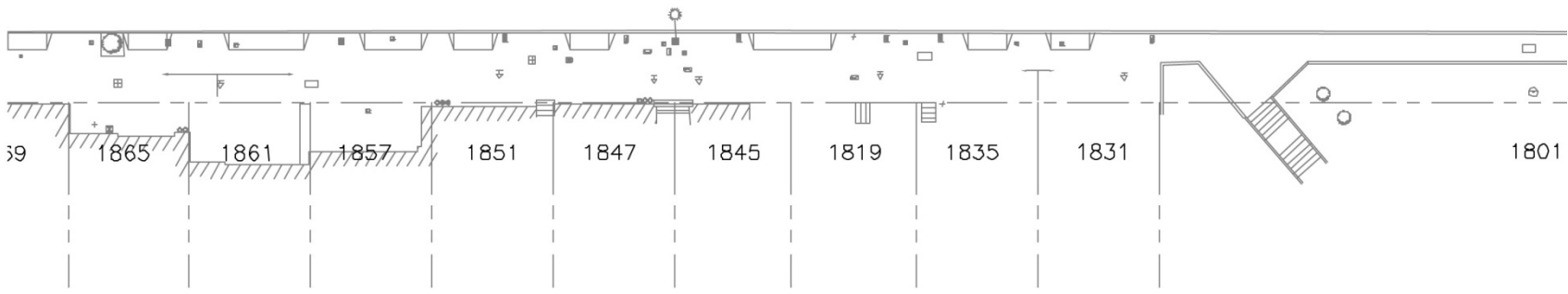

Newhall Street

Recent plan

- bulb-out
- planted median island

Proposed:

- Removed 3 bulb-outs
- planted median island

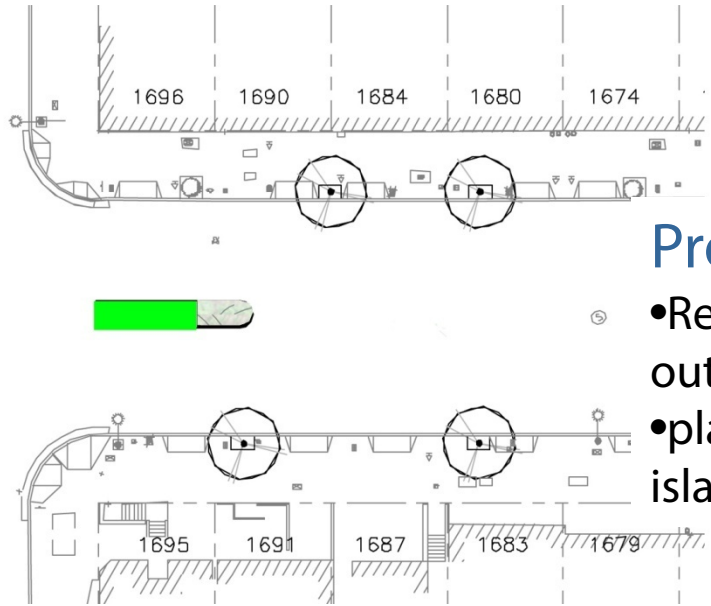
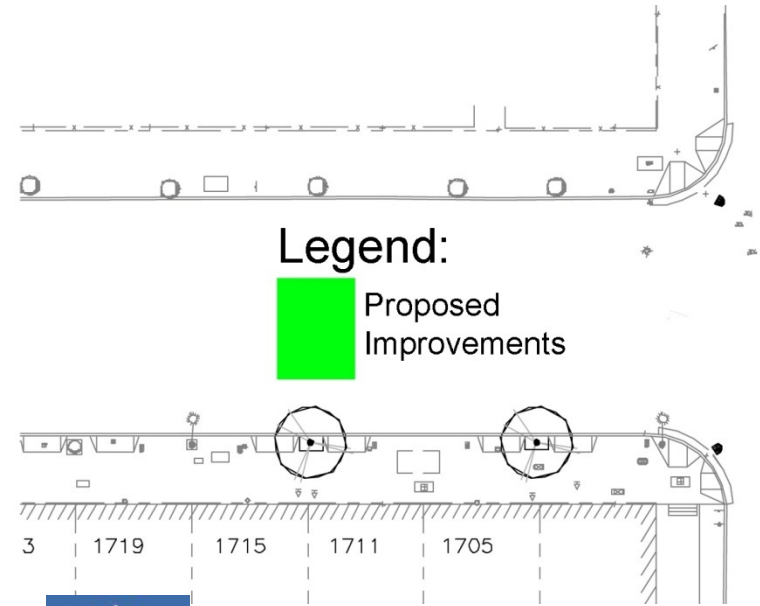
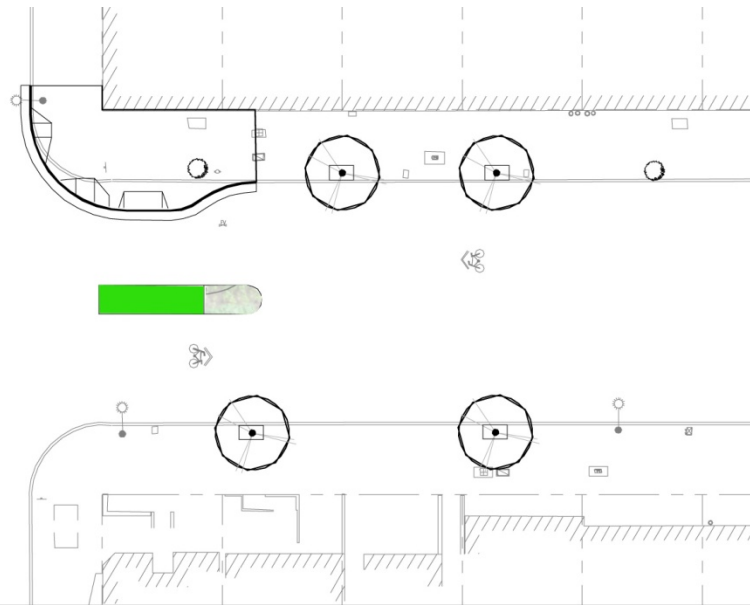
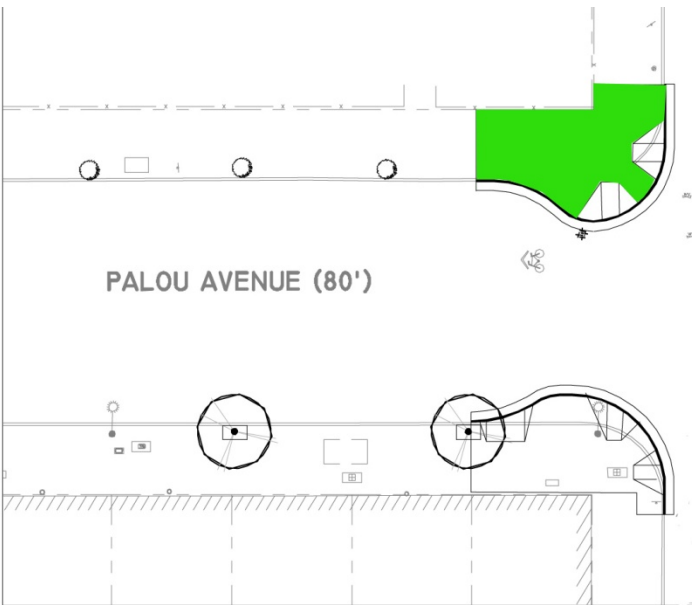

Legend:

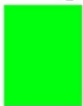
 Proposed Improvements

NEWHALL

3rd Street

No change

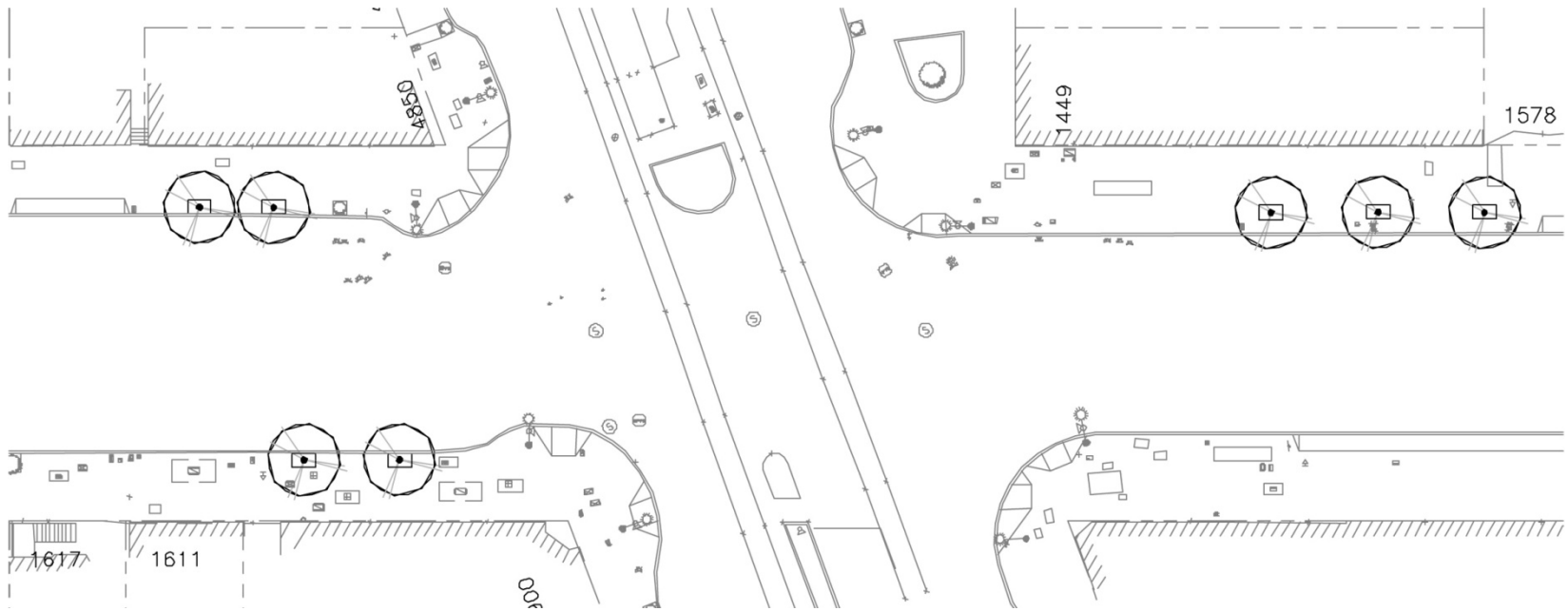

Lane Street

Recent plan:

- Add three bulb-outs

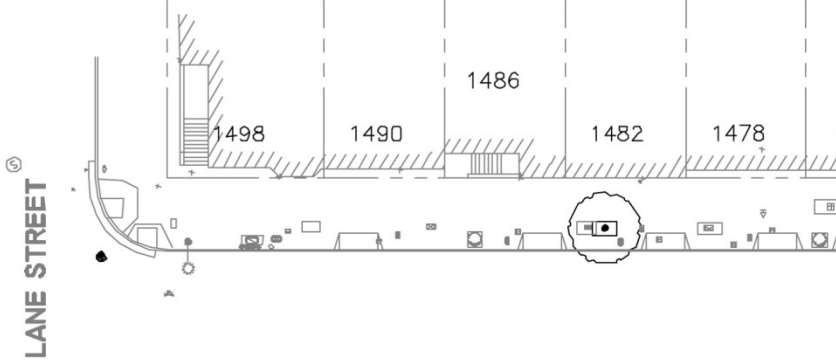
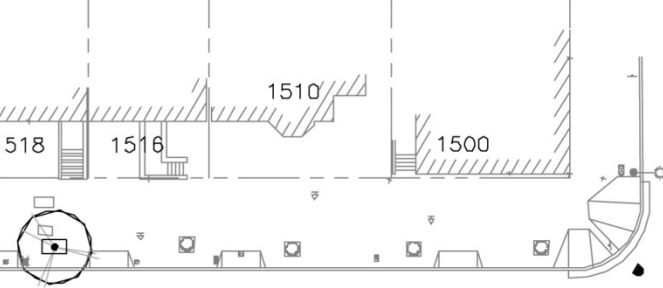
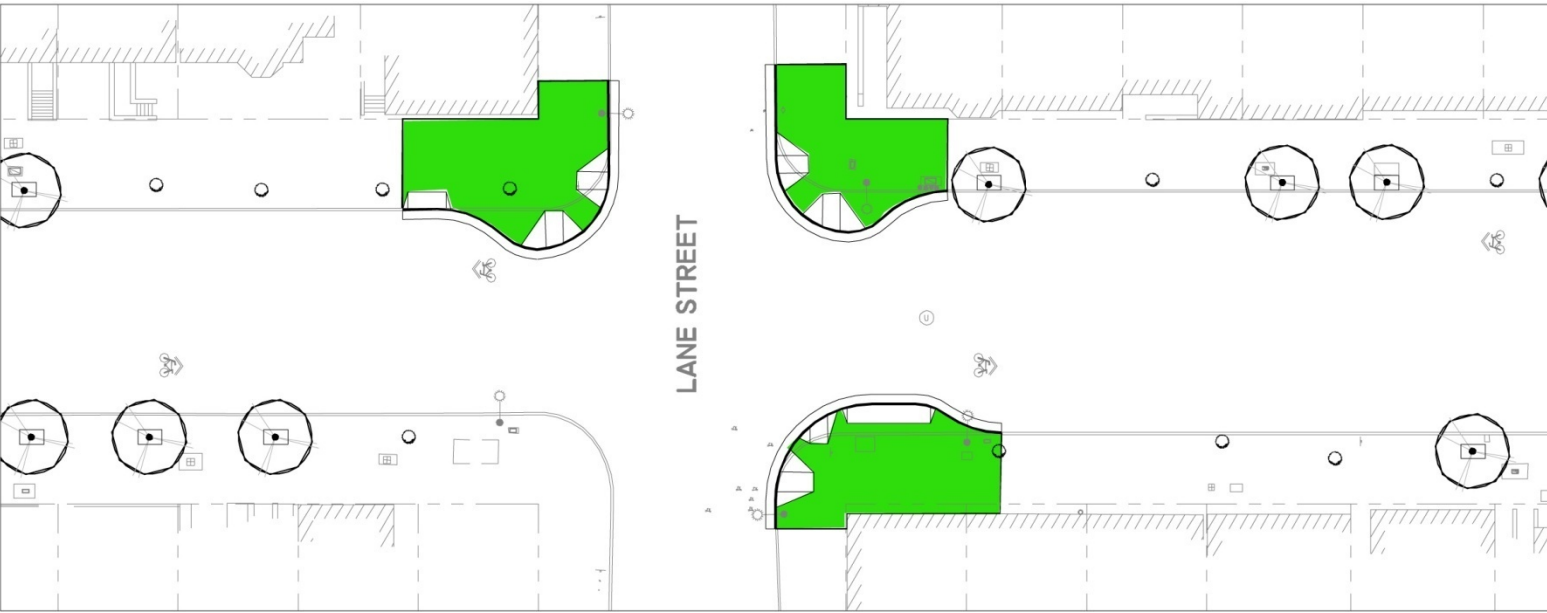

Proposed:

- Removed 3 bulb-outs

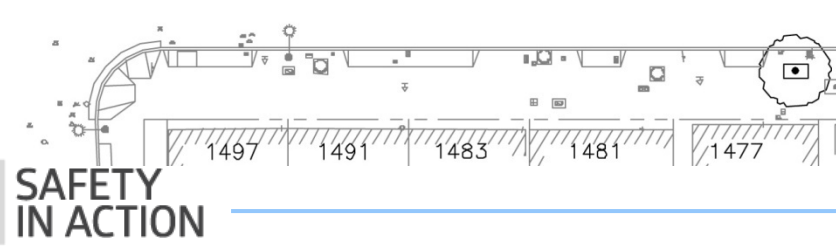
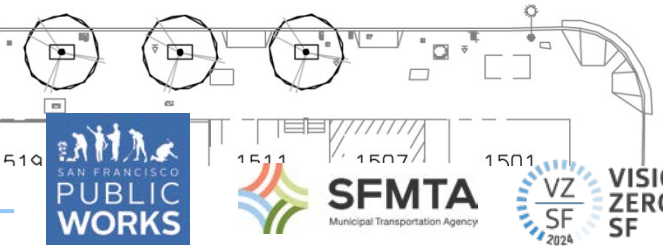

SAFETY IN ACTION

Keith Street

Recent plan

- bulb-out
- planted median island

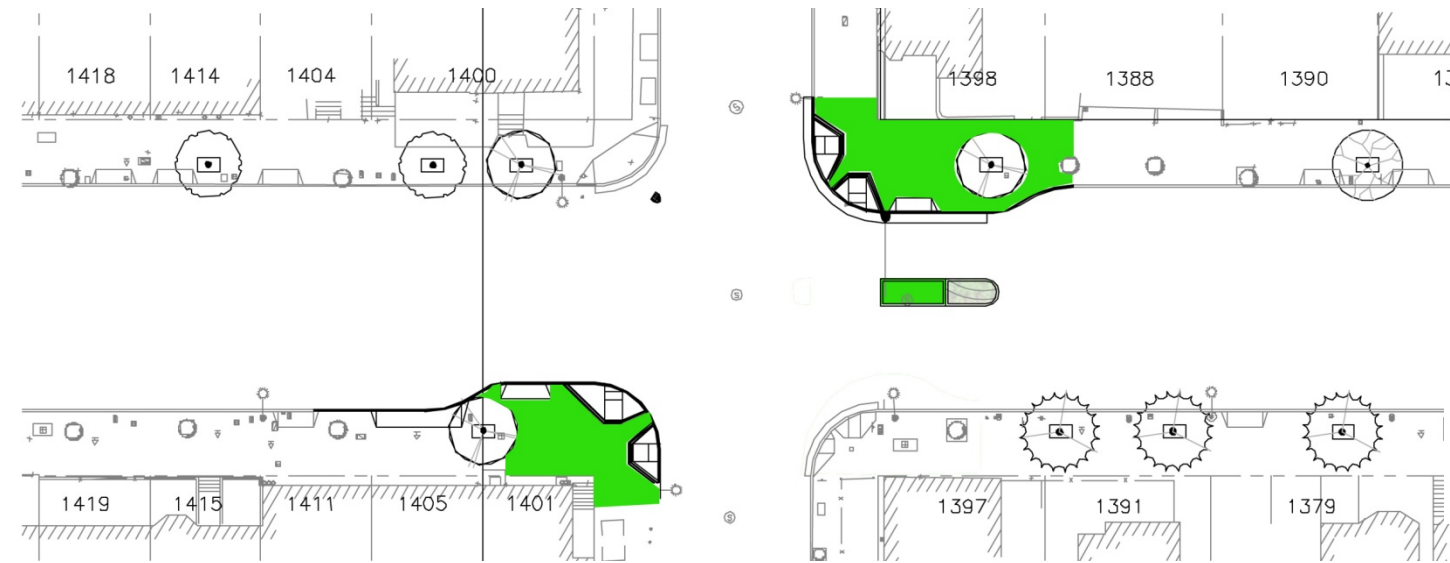
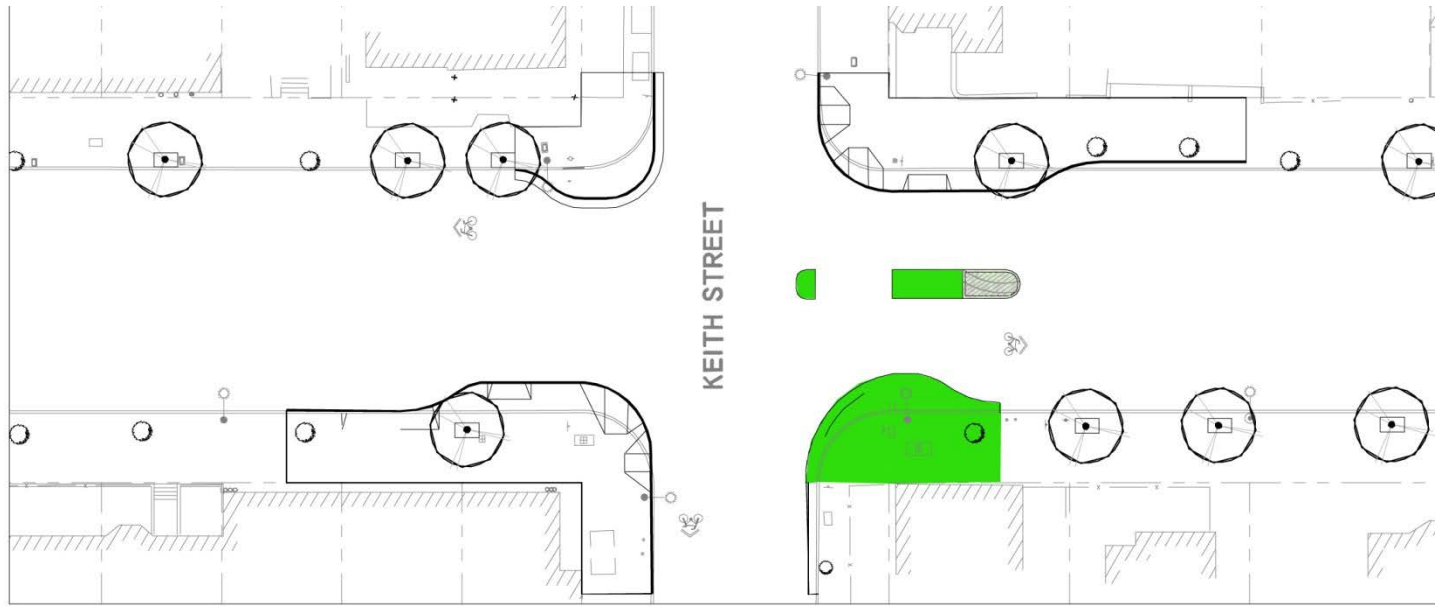

Proposed:

- Removed 2 bulb-outs
- planted median island modified

Jennings Street

Recent plan

- bulb-out
- planted median island

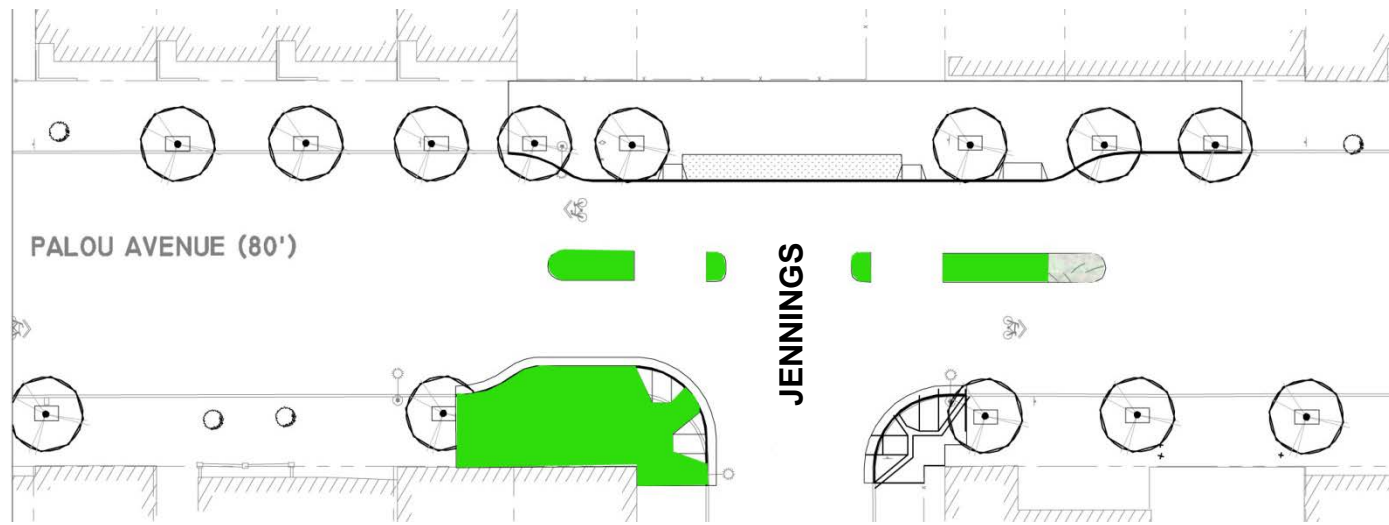

Proposed:

- No change

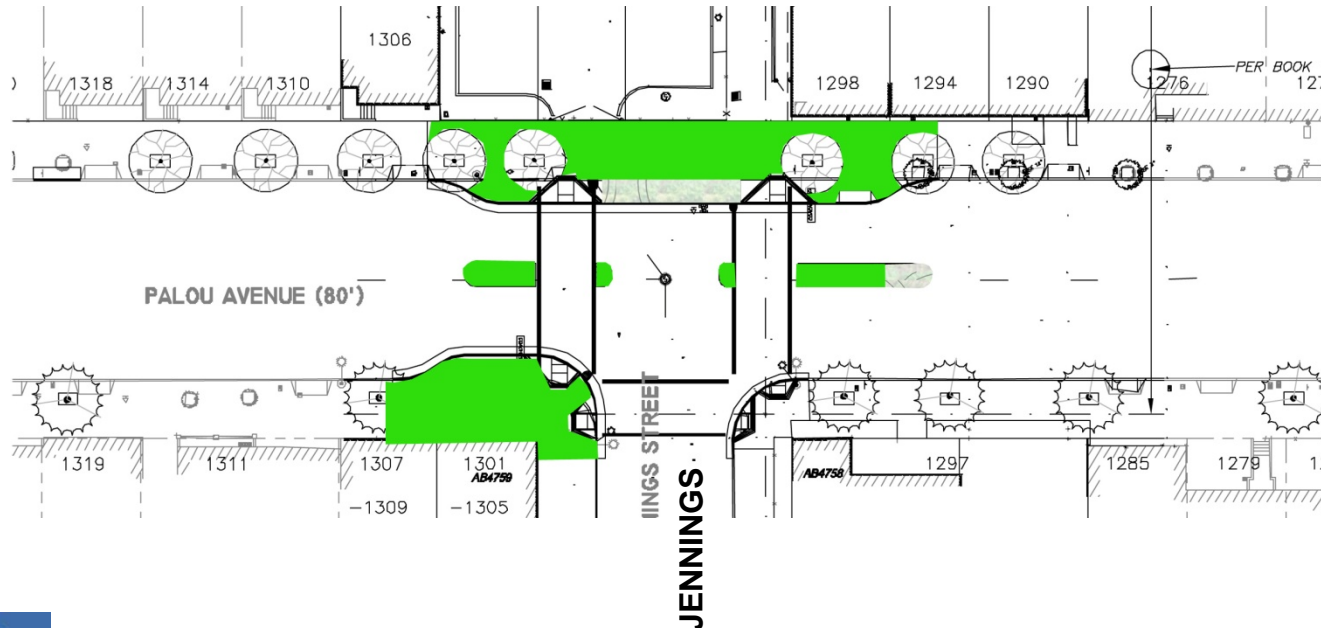

Ingalls Street

Recent plan:

- planted median islands

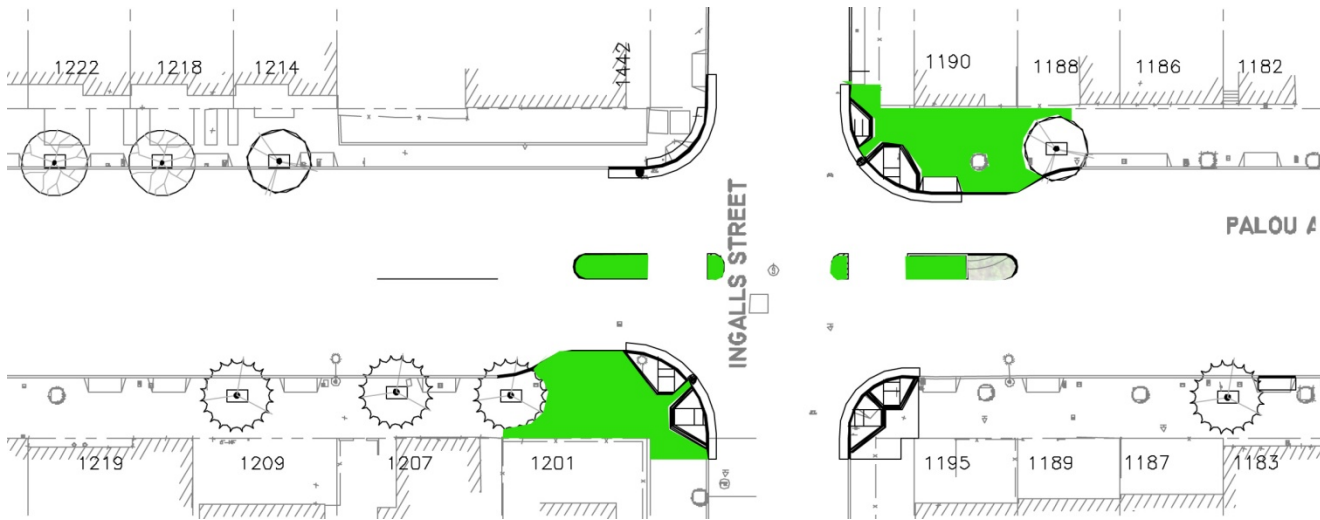
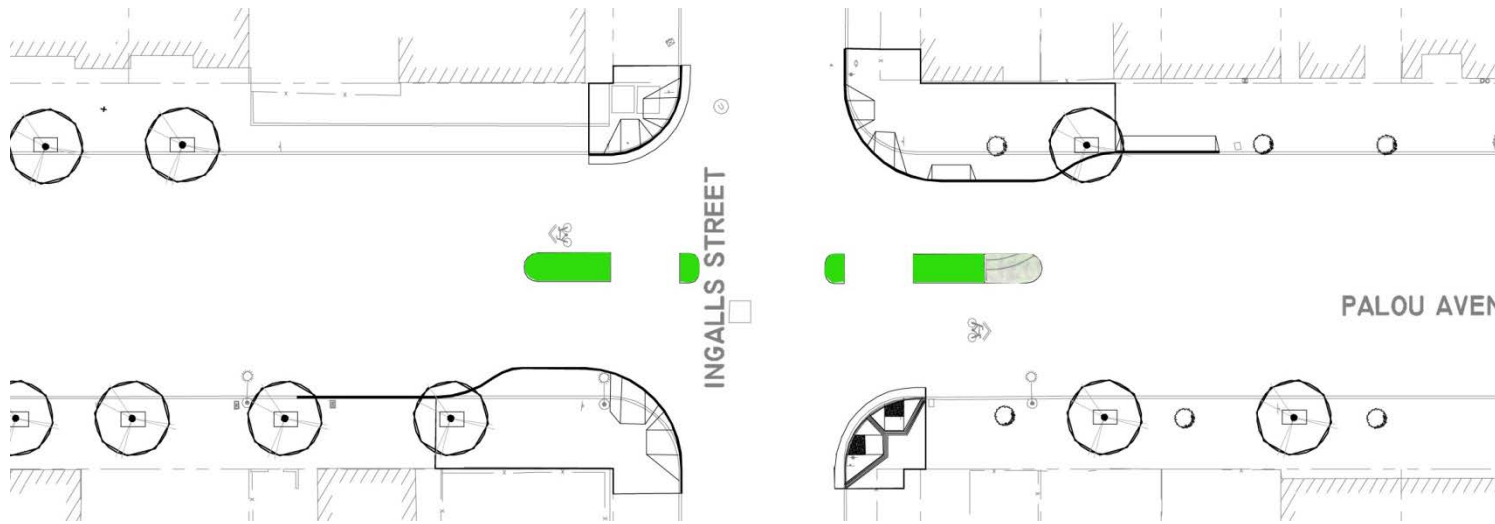

Proposed:

- Shortened ped bulb
- planted median islands

Hawes Street

Recent plan:

- bulb-out
- planted median island

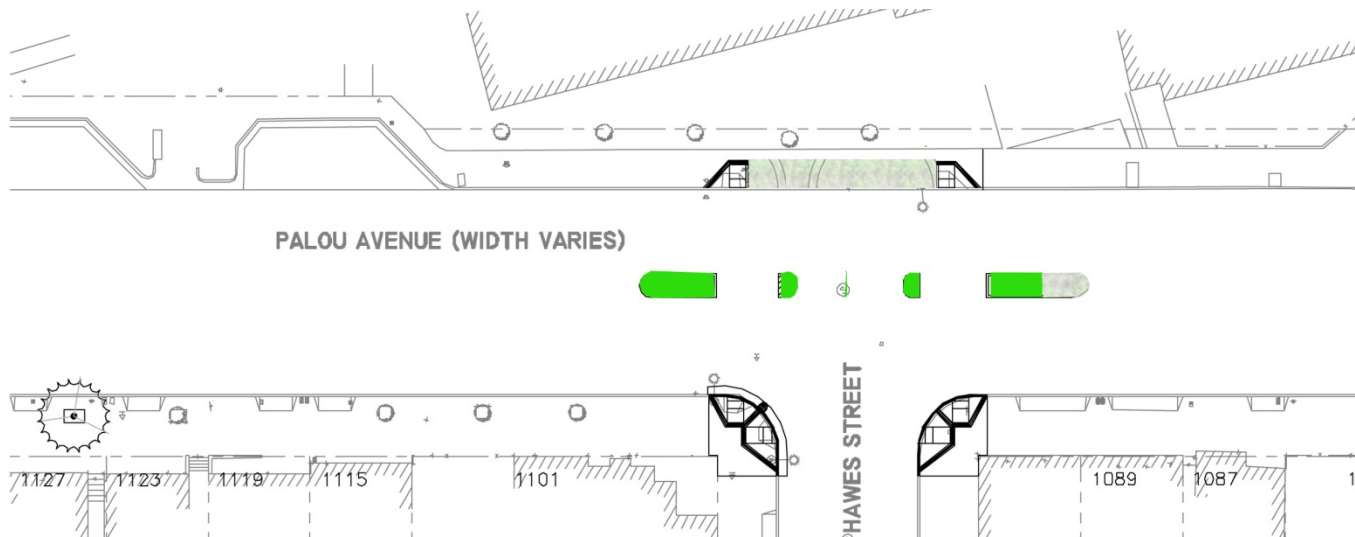
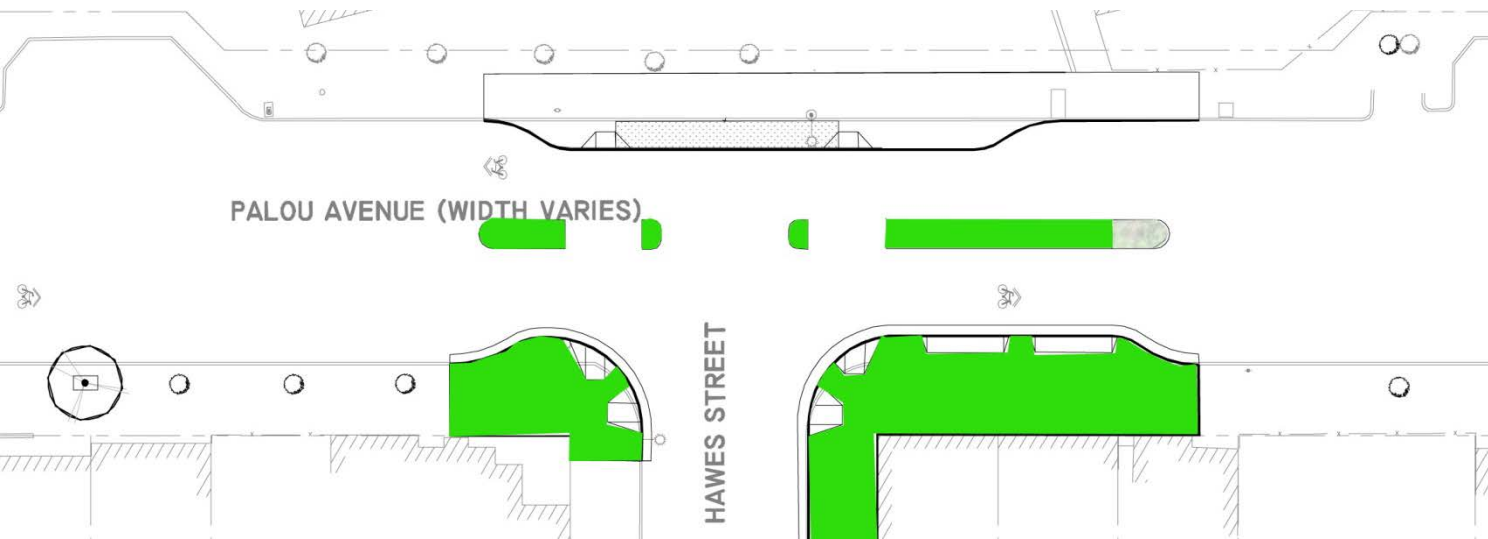

Proposed:

- Removed 3 bulb-outs
- Smaller planted median islands

Jennings Plaza Lot

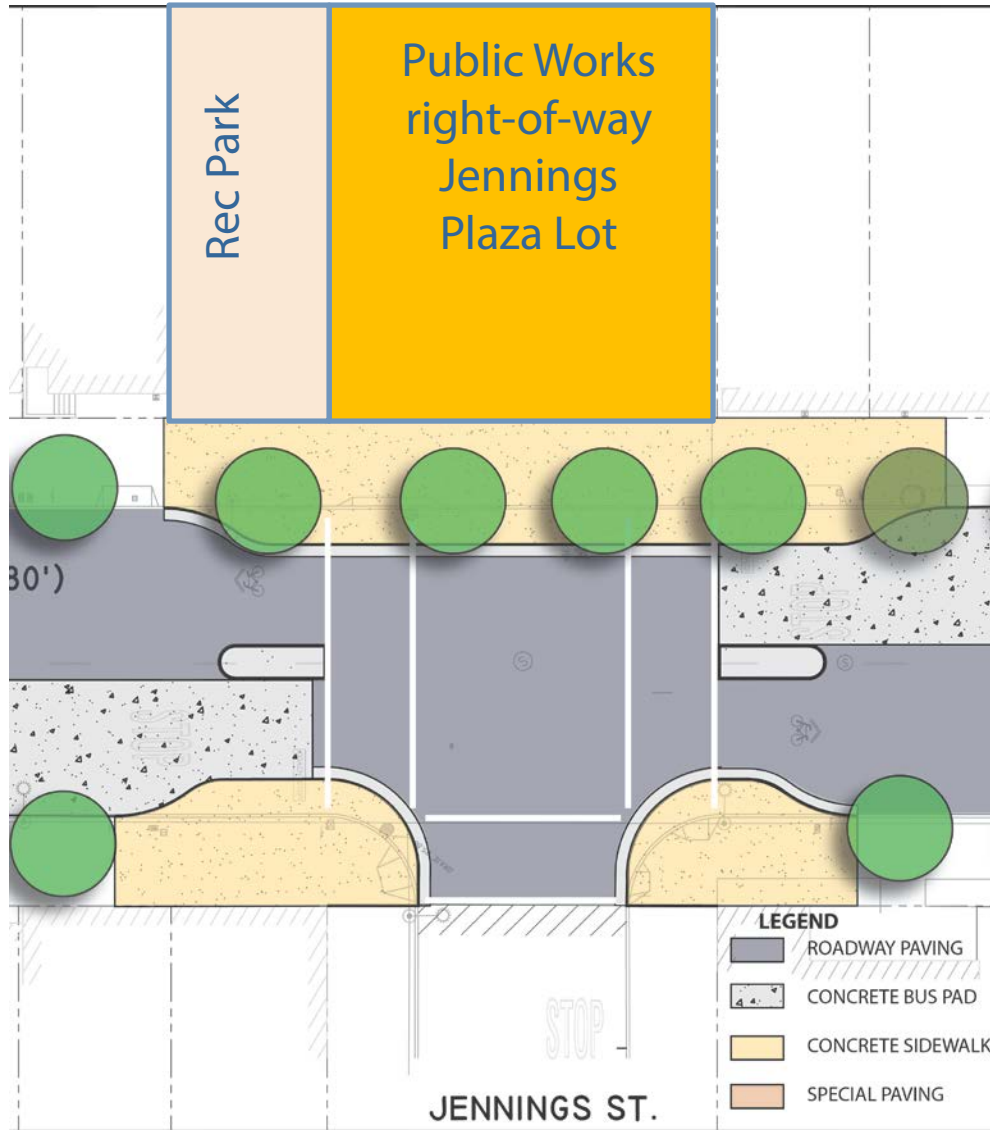

Introduction:

Bill Bulkley, Landscape Architect

Recap:

- At the first community meeting the neighbors brought up locations of blighted vacant lots that they would like to see transformed into positive space for the community
- The team researched who owned the lots. The largest lot turned out to be a Public Works right of way
- Ideas were discussed as to how the space could be used such as:
 - amphitheater
 - farmer's market on Saturdays
 - children's playground
 - mini-park
 - plaza
 - Exercise
 - and/or multi use
- A grant of \$450,000 was applied for and approved from OCII. This grant is for construction funding only
- Public Works is providing design services

We need your help:

- Community sponsorship
- Prioritize design elements versus construction budget

The Plaza needs sponsorship and a maintenance plan in order to be built.

- We researching the San Francisco Plaza Program, under the Real Estate Division as a resource to help the community to sponsor the Plaza and develop a maintenance plan (web address on last page of presentation)

Plaza steward:

- A person or group in the community who champions the Plaza project
- The steward needs a registered Non-profit organization as their sponsor.

What local non-profits may be able to help?

- Parks Alliance?, Friends of ?, Quesada Gardens?
- Is there a nearby Community Benefit District (CBD)? Or Homeowners Group?
- Other ideas?

Why is a steward necessary?

Why is a maintenance program required?

PROCESS & REQUIREMENTS CITY PLAZAS

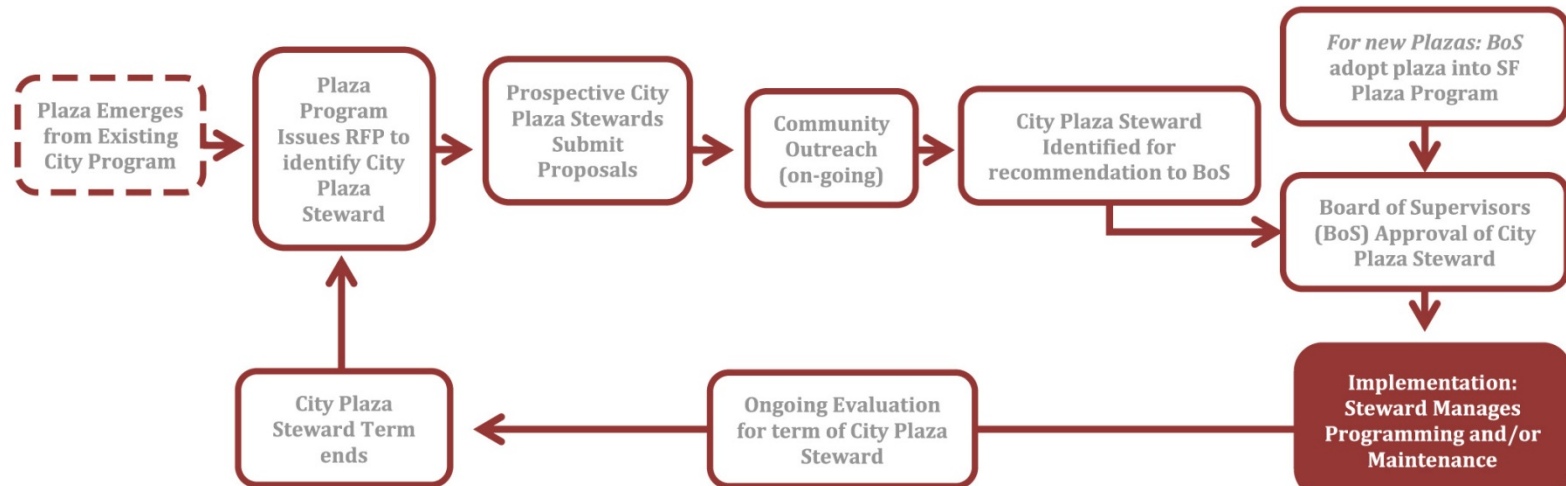

Jennings Plaza Lot: Existing Site Conditions



Left : View of front of lot from Palou Ave.
Left below: View from lot down Jennings
Below: Aerial view of lot



Jennings Plaza Lot: Cross Section

through center of the lot

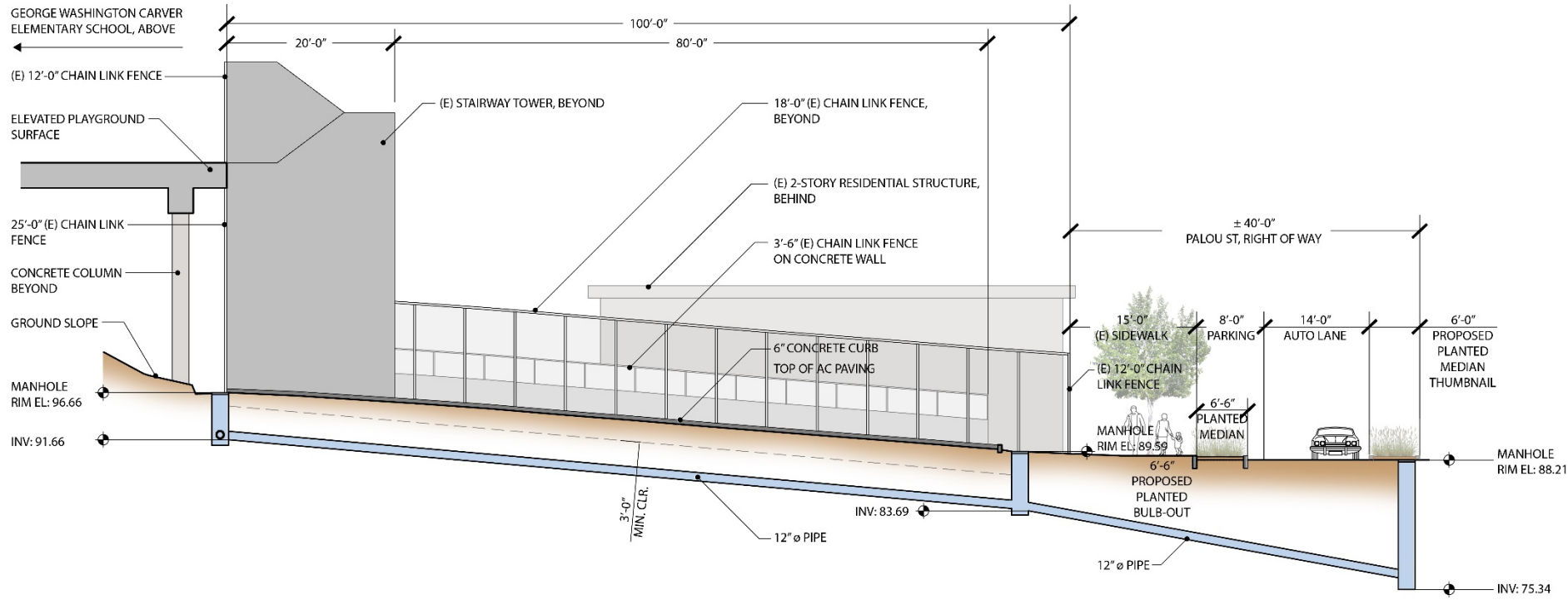

SAFETY IN ACTION

Jennings Plaza Lot: Site Analysis

Opportunities and Constraints

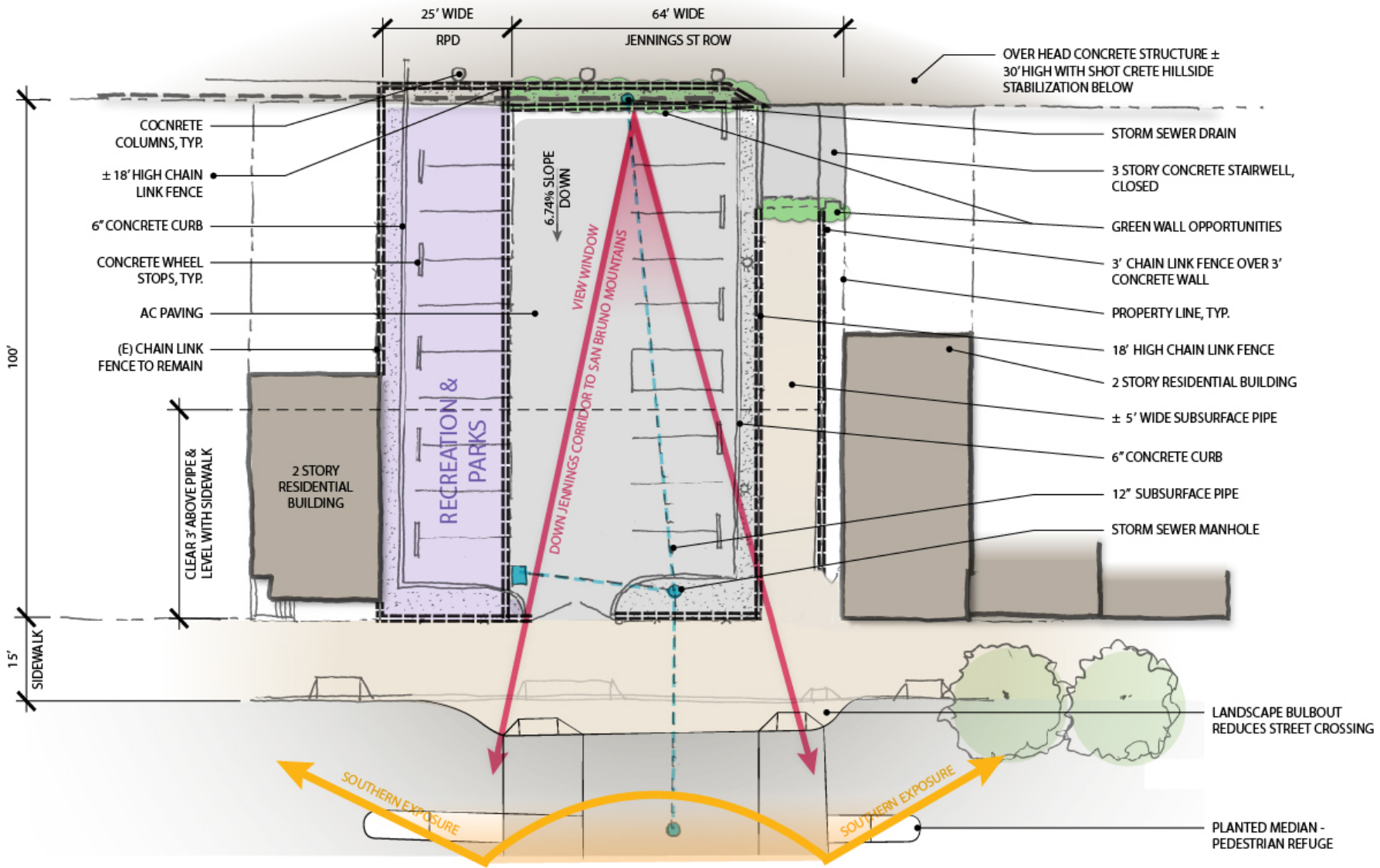

SAFETY IN ACTION

Jennings Plaza Lot: Design concept: the big idea



Not enough construction budget to build the “big idea”

What are your ideas for plaza use / programming?

What are your ideas on prioritizing design elements to match the construction budget?

What days and times should the Plaza be open?

Who has the gate key?

Jennings Plaza Lot: Programming and Construction

Total Construction Budget	\$450,000
Necessary construction items	
Demo and Grading of lot	Must do
Civil/Stormwater (drainage)	Must do
standard concrete retaining walls and ramps – ADA Access	Must do
New Paving	Must do
New fences and gates	Must do
Irrigation	Must do
Planting: trees and plants	Must do
Programming priorities	
Is a farmers market/flexible use plaza important?	
Is children’s play important? Can it be incorporated into the larger design?	
Is an amphitheater/stage backdrop important for occasional use?	
Other ideas?	
Elements that can be prioritized	
Play surface for features for kids play features, need a safer surface for kids	
Is a storage / shed/ sales for events & supplies a good idea?	
Is a shade structure a good idea?	
Is Lighting necessary? Will most likely have to be solar LED	
Upgrade fence to art fence or decorative metal & gate?	
Are vines for a green screen a good idea?	



Design elements versus cost

Prioritize design elements versus construction budget

Title VI of the Civil Rights Act of 1964 states:

- Title VI prohibits discrimination on the basis of race, color, and national origin in programs and activities receiving federal financial assistance.
- San Francisco Public Works wants to ensure that residents and communities impacted by this project have been included in the decision making process.
- Participation in the Title VI questionnaire assists Public Works in assuring that we have an effective and representative community outreach program



Next steps:

Turn in Questionnaire by August 10, 2016

Next Step: Jennings Plaza Lot stewardship: who can be the steward?

Plaza Program: visit:

<http://sfgov.org/realestate/plaza-program>

SFMTA: notices will be placed on street poles 10 days before SFMTA Public Hearing. Watch website for SFMTA Public Hearing date:

<https://www.sfmta.com/about-sfmta/organization/divisions-and-units/sustainable-streets>

Summer/Fall 2016: Tree removal and planting notices will be posted on tree or mailed to adjacent property owners

For project updates, visit:

sfpublicworks.org/palou



**SAFETY
IN ACTION**

Questions?

Thank you for participating!



VISION
ZERO
SF

SAFETY
IN ACTION