

UPDATE

CORONA HEIGHTS PARK

City & County of San Francisco

STATION RECOVERY & OBSTRUCTION FORM

STATION ID: 101 Set by: BS, RH SB, RA Date: 5/24/13

Monument Desc: 3 1/4" DOMED BRASS DISK 10/27/14

Station Description: SET PUNCHED & STAMPED "CCSF MONUMENTATION"

NETWORK CONTROL MONUMENT L.S. 6914". IN 2" x 18" STEEL PIPE SET IN CEMENT WITH REBAR STEM ON NORTHERLY ROCK OUTCROPPING AT THE TOP OF CORONA HEIGHTS PARK, 5' WESTERLY OF 10' WIDE x 6' TALL BOULDER @ NORTHERLY EXTENT OF OUTCROPPING. 12.2' SOUTHEASTERLY OF 2.5' HIGH WOOD SIGN POLE.

***PT. IS REFERENCED BY 3 - CHISEL CUTS ON TOP OF ADJACENT ROCKS:

- 1) "V" CUT SET ON TOP OF ROCK 2.5' NORTHERLY OF BD.
2) "V" CUT SET 4.0' EASTERLY.
3) "*" STAR CUT SET 10.5' SOUTHERLY.

Travel Time: Pack Distance: 5-10 MIN.

Public | Private | Locked Gate | Parking Adjacent | Offroad | 4W Drive

Key Required: Contact/Permission:

Other Information APPROX. 200 M. FROM ADJACENT STREET 12. ROOSEVELT WY / MUSEUM WY.

FIELD SKETCH

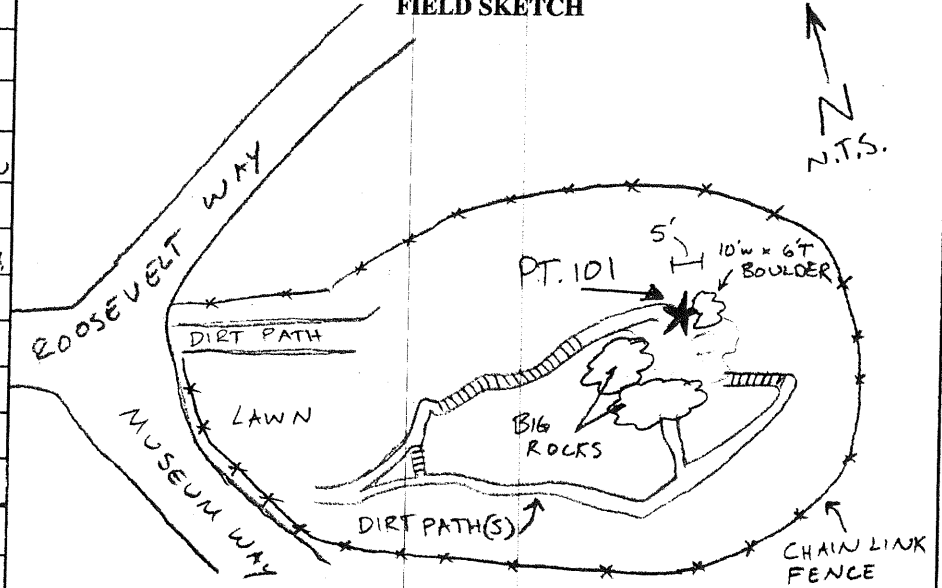

OBSTRUCTIONS

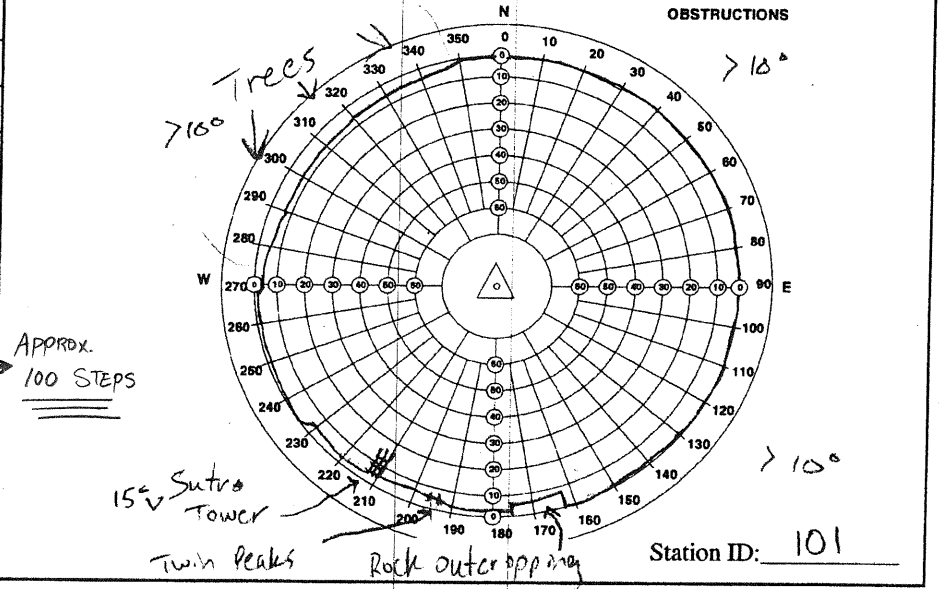

LINCOLN PARK

City & County of San Francisco

STATION RECOVERY & OBSTRUCTION FORM

STATION ID: 106

Set by: BS/RH/SB/RA Date: 5/23/13

Monument Desc: 2" DOMED BRASS DISK

Station Description: PUNCHED & STAMPED "CLSF SURVEY

MONUMENT U.S. 6919"

SET
IN NORTHERLY CONCRETE SIDEWALK SURROUNDING
PLAYGROUND AREA OF LINCOLN PARK.

6.5' NORTHERLY OF CURB FACE.

15' EASTERLY OF EASTERMOST EDGE OF CONCRETE "LINCOLN
PARK" SIGN.

32' NORTHERLY OF THE EASTERLY END OF A PLAYGROUND
STRUCTURE RESEMBLING THE BOW OF A BOAT.

Travel Time:

Pack Distance:

Public | Private | Locked Gate | Parking Adjacent | Offroad | 4W Drive

Key Required:

Contact/Permission:

Other Information

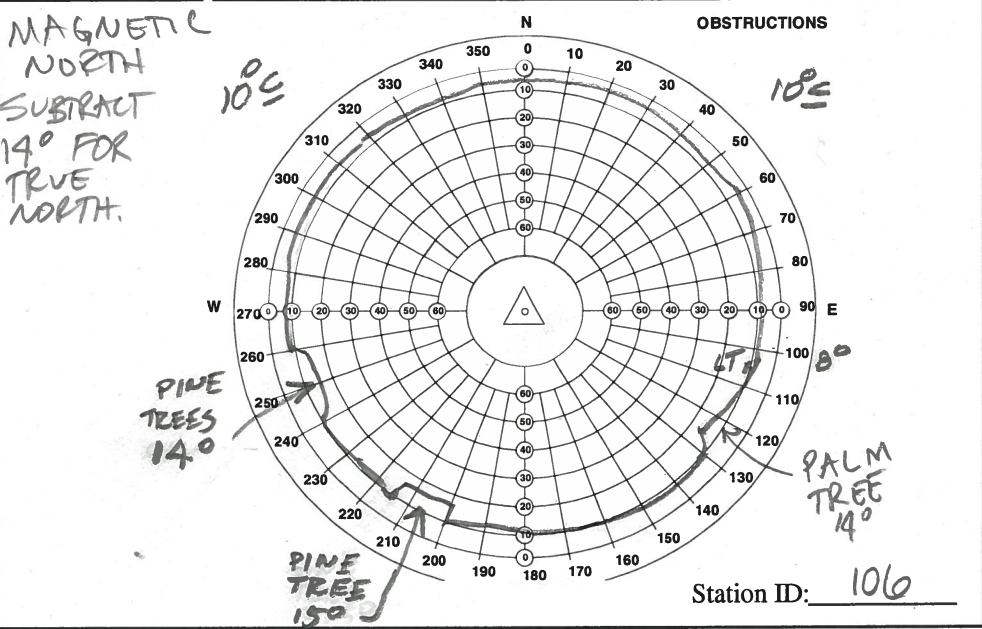
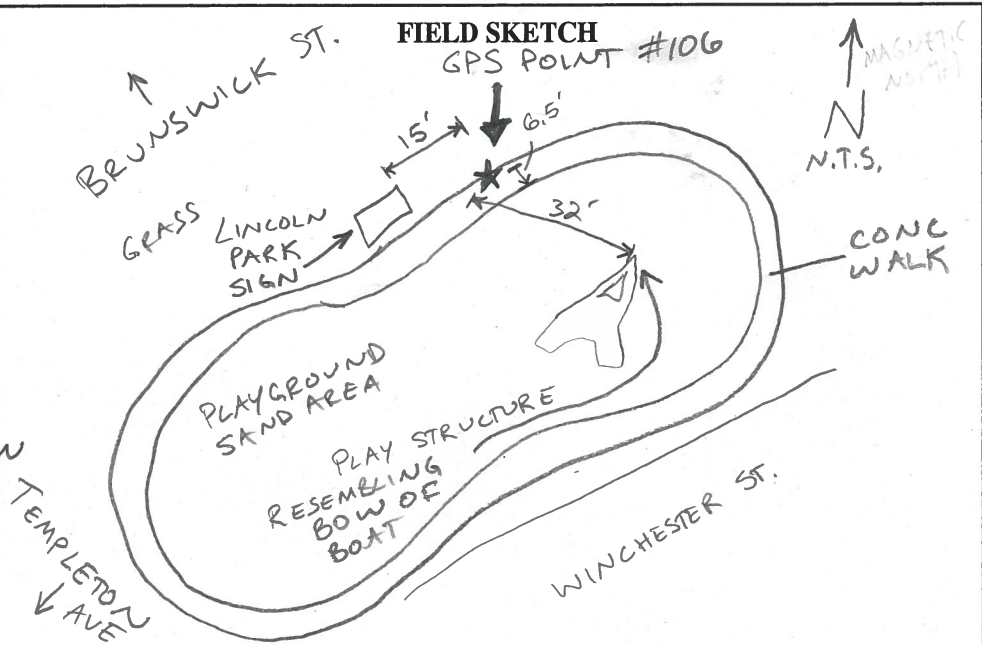

CANDLESTICK

City & County of San Francisco

STATION RECOVERY & OBSTRUCTION FORM

STATION ID: 107 Fnd Set by: SB Date: 7/21/08

Monument Desc: 2 1/2" DOMED ALUMINIUM DISK

Station Description: PUNCHED & STAMPED "09-GF".

SET BY CALTRANS ON TOP OF A RETAINING WALL

@ EASTERLY (BAY) SIDE OF AN ASPHALT PATH

WHICH RUNS PARELLEL (EASTERLY) OF HARNEY WAY.

136' NORTHERLY OF AN IRON ACCESS GATE LEADING TO THE ASPHALT PATH.

5' NORTHERLY OF WHERE THE CONCRETE AREA

NORTH OF THE GATE ENDS AND THE ASPHALT PATH BEGINS.

Travel Time:

Pack Distance:

Public | Private | Locked Gate | Parking Adjacent | Offroad | 4W Drive

Key Required:

Contact/Permission:

Other Information

FIELD SKETCH

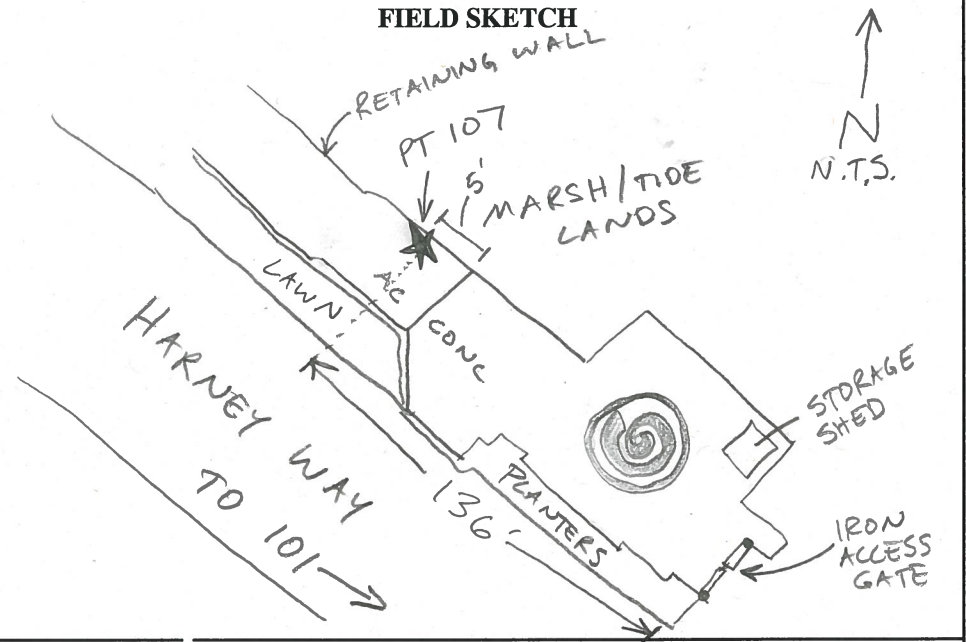

MAGNETIC NORTH
SUBTRACT
M° FOR
TRUE
NORTH

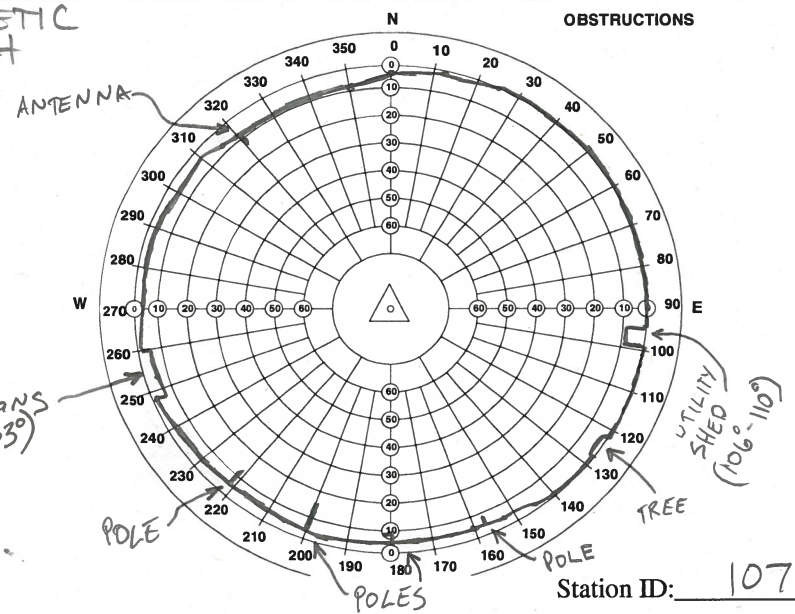

Station ID: 107

CHINA BASIN PARK

City & County of San Francisco

STATION RECOVERY & OBSTRUCTION FORM

STATION ID: 109 Set by: SB/RA Date: 5-28-13

Monument Desc: 2" DOMED BRASS DISK

Station Description: PUNCHED & STAMPED, "CCSF SURVEY

MONUMENT L.S. 69/4"

SET IN CONCRETE SIDEWALK AT EAST END OF CHINA

BASIN PARK, ABOUT 10' SOUTH OF NORTHERLY CURB LINE OF TERRY FRANCOIS BLVD (PROJECTED).

3' EASTERLY OF 1.5' HIGH CONCRETE WALL/BENCH DISPLAYING BASEBALL PLAQUES & TILES.

Travel Time:

Pack Distance:

Public | Private | Locked Gate | Parking Adjacent | Offroad | 4W Drive

Key Required:

Contact/Permission:

Other Information

FIELD SKETCH

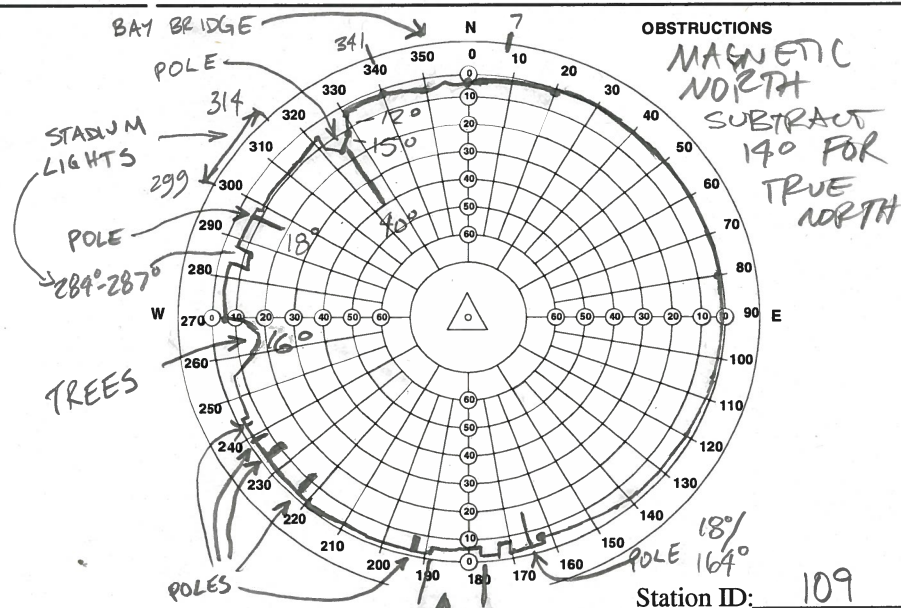
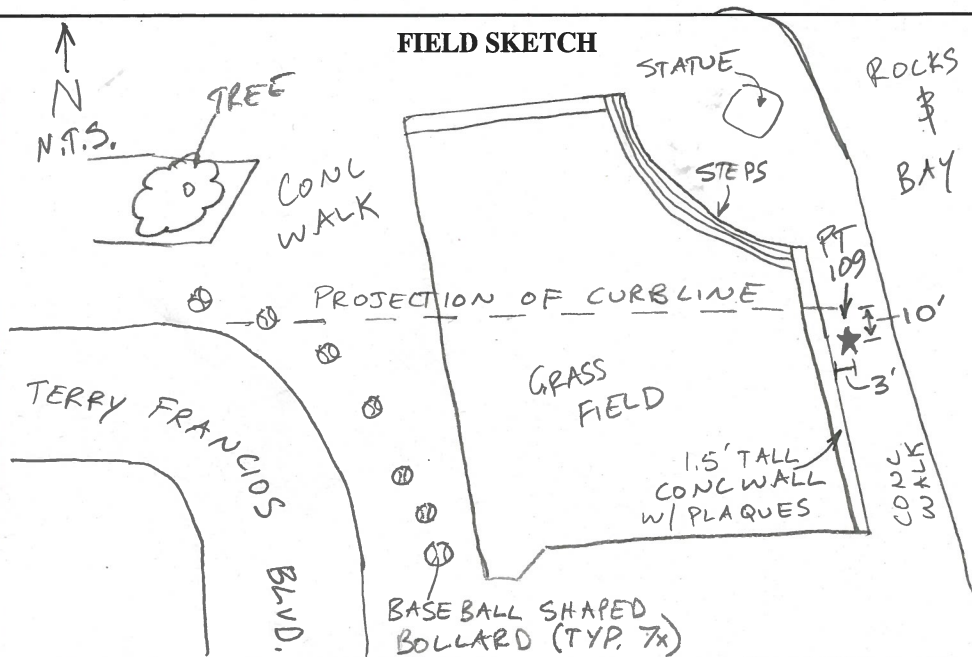

STATION RECOVERY & OBSTRUCTION FORM	
STATION ID: 110	Set by: SB/RA Date: 5/28/13
Monument Desc: 2" DOMED BRASS DISK	
Station Description: PUNCHED & STAMPED "CCSF SURVEY	
MONUMENT L.S. 69/4"	
SET IN CONCRETE SIDEWALK ON NORTHERLY SIDE OF THE EMBARCADERO, OPPOSITE #93 JEFFERSON STREET "SF GIFT SHOP".	
7'-70' EASTERLY OF WESTERLY ANGLE POINT OF 4' HIGH CHAINLINK FENCE WITH WOODEN RAILING, WHERE THE FENCE RUNS NORTHWESTERLY TOWARDS THE NORTH SIDE OF THE "FRANCISCAN CRAB RESTAURANT".	
3' EASTERLY OF THE EASTERLY EXTENT OF THE WESTERNMOST GROUP OF 10 BENCHES PARALLEL TO THE EMBARCADERO.	
21.4' NORTHERLY OF THE NORTHERLY FACE OF CURB OF THE EMBARCADERO.	
24' EASTERLY OF CENTER/CENTER CATCH BASIN.	
Travel Time:	Pack Distance:
Public Private Locked Gate Parking Adjacent Offroad 4W Drive	
Key Required:	Contact/Permission:
Other Information	

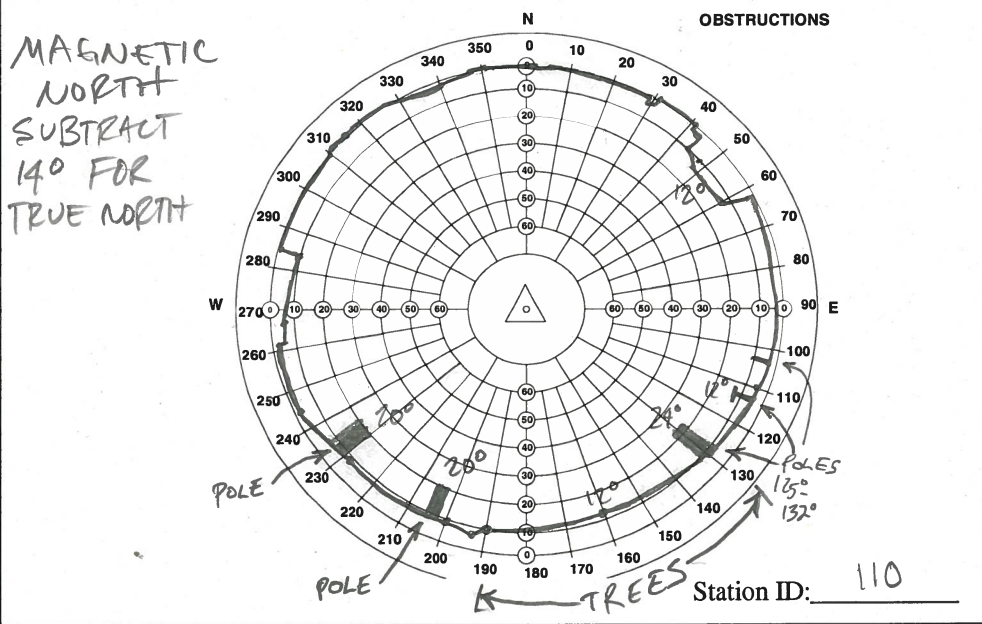
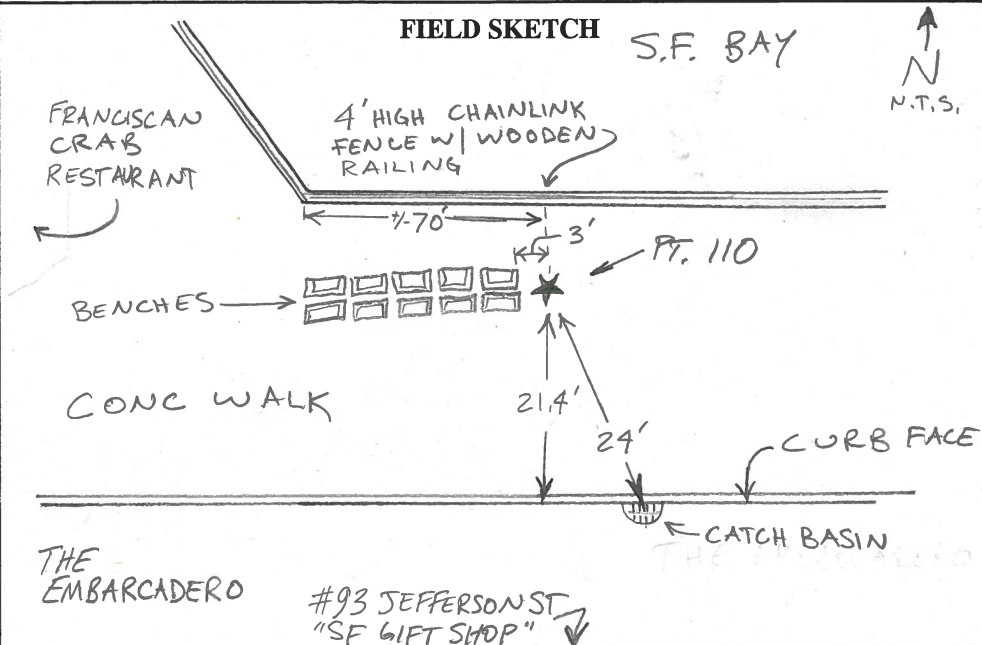

CRISSY FIELD / TIDAL 181

City & County of San Francisco

STATION RECOVERY & OBSTRUCTION FORM	
STATION ID: 111	Fnd Set by: SB/KV/MT Date: 9/26/11
Monument Desc: 3 1/2" DOMED BRASS DISK	
Station Description: PUNCHED & STAMPED "181 1945"	
FOUND ON TOP OF 2' THICK CONCRETE SEAWALL NORTH OF PARKING LOT TO GULF OF THE FARALLONES MARINE PRESERVATION CENTER.	
AT NORTHWESTERLY CORNER OF SEAWALL WHERE IT INTERSECTS WITH DRIVEWAY/ENTRANCE TO PARKING LOT.	
Travel Time:	Pack Distance:
Public Private Locked Gate Parking Adjacent Offroad 4W Drive	
Key Required:	Contact/Permission:
Other Information	

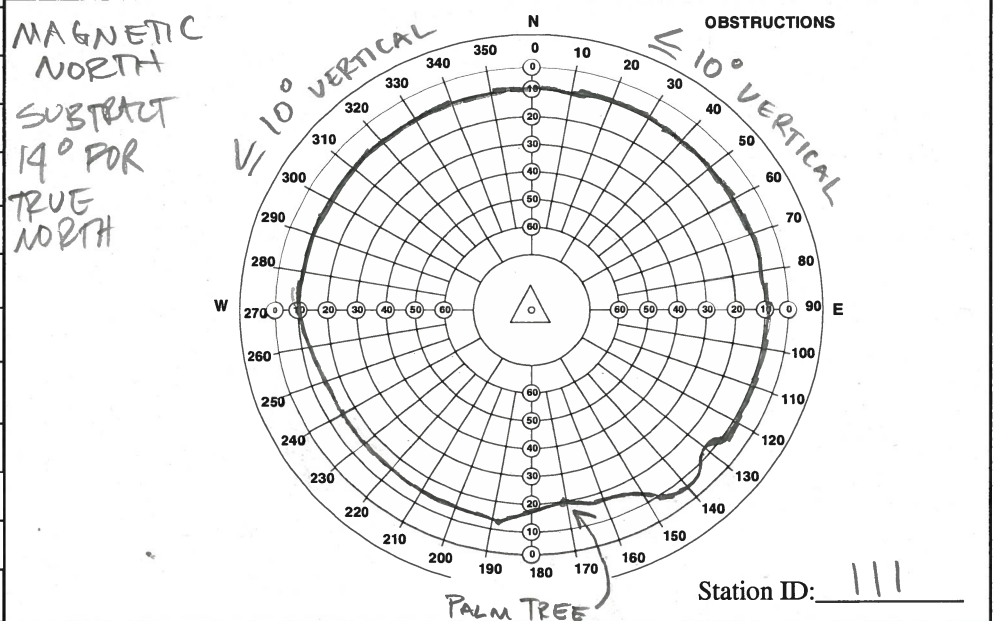
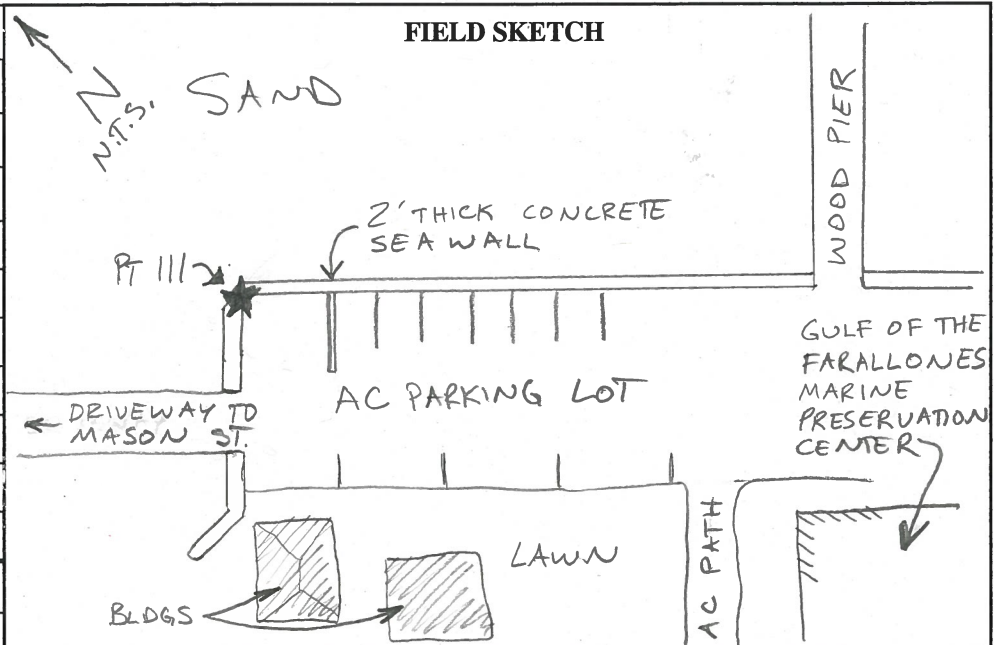

STATION RECOVERY & OBSTRUCTION FORM	
STATION ID: 112	Set by: SB, RA Date: 6-13-13
Monument Desc: 2" DOMED BRASS DISK	
Station Description: SET 2" DOMED BRASS DISK STAMPED	
"CCSF SURVEY MONUMENT DO NOT DISTURB L.S. 6914"	
W/ "Δ" AND CENTER PUNCH.	
SET IN LOBOS VALLEY OVERLOOK PARKING LOT IN	
THE PRESIDIO, SW'LY OF PRESIDIO LANDMARK BUILDING	
1801.	
IN CENTER OF CONC PAD AT W'LY MOST	
EXTENT OF PARKING LOT IN FRONT OF "LOBOS	
CREEK VALLEY" INFORMATION PLAQUE.	
6' SE'LY OF 5' WIDE CONC WALK LEADING	
FROM PARKING LOT TO AC PATH AND TO LOBOS	
VALLEY OVERLOOK OBSERVATION POINT.	
12' SE'LY OF "PRESIDIO TRAILS" MAP/SIGN.	
NW'LY OF PARKING SPACE # 446.	
26' SE'LY OF CL ENT TO PARKING LOT FROM	
WEDEMEYER ST.	
Travel Time:	Pack Distance:
Public Private Locked Gate Parking Adjacent Offroad 4W Drive	
Key Required:	Contact/Permission:
Other Information	

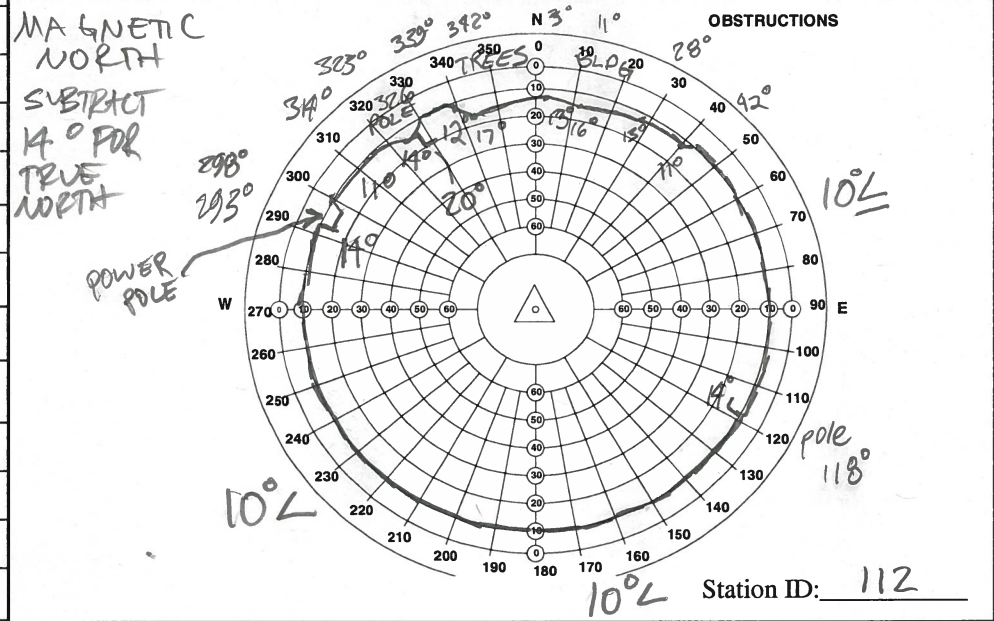
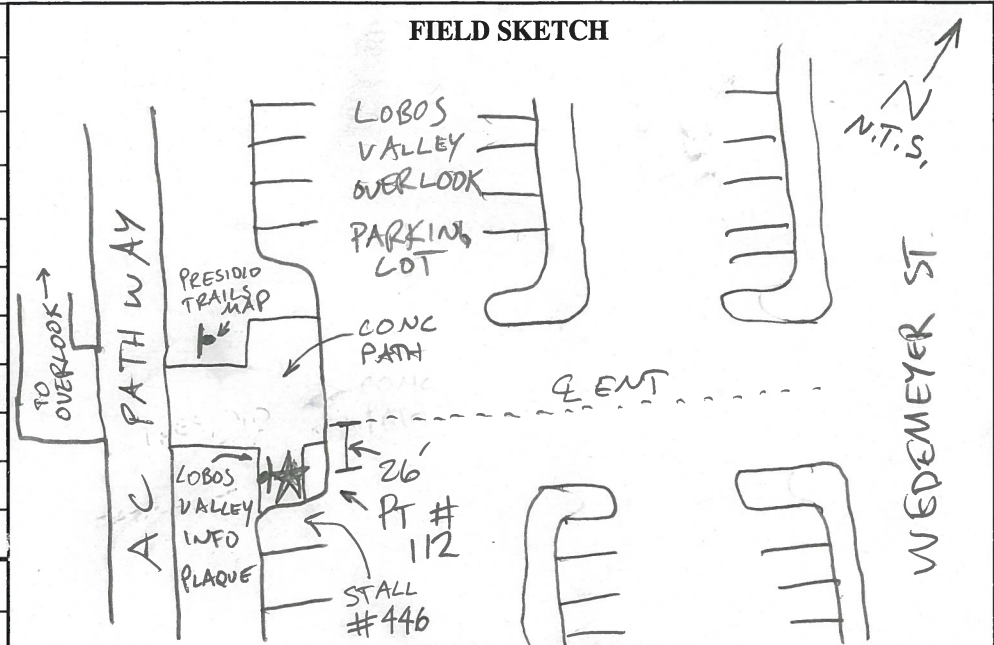

STATION RECOVERY & OBSTRUCTION FORM	
STATION ID: 113	Set by: SB, RA Date: 6-13-13
Monument Desc: 2" DOMED BRASS DISK	
Station Description: SET 2" DOMED BRASS DISK STAMPED "CCSF SURVEY MONUMENT DO NOT DISTURB L.S. 6914" W/ Δ AND CENTER PUNCH.	
SET AT SW'LY END OF 1.1' W x 1.2' H CONC HEAD WALL AT SE'LY EDGE OF AC PATH RUNNING ABOVE THE PEDESTRIAN ENT/EXIT TO MUSIC CONCOURSE UNDERGROUND PARKING GARAGE.	
78' SW'LY OF SW'LY EDGE OF STAIRS LEADING FROM MUSIC CONCOURSE TO DE YOUNG MUSEUM (NE'LY OF SAID GARAGE ENTRANCE/EXIT).	
2' SW'LY FROM SW'LY END OF 3' H METAL RAILING.	
13' NE'LY OF E'LY & PT OF CFC@ NE'LY EXTENT OF CONC HCR LEADING TO MUSIC CONCOURSE.	
35' SE'LY OF CC HIGH PRESSURE FIRE HYDRANT, OPPOSITE SW'LY END OF WOODEN BENCH DEDICATED TO "DORIAN CROCKER ADAMS".	
Travel Time:	Pack Distance:
Public Private Locked Gate Parking Adjacent Offroad 4W Drive	
Key Required:	Contact/Permission:
Other Information	

FIELD SKETCH

DE YOUNG MUSEUM } (ACROSS STREET) ↑

HAGIHARA TEA GARDEN DRIVE

"DORIAN CROCKER ADAMS"

BENCHES 35' 78'

AC PATH 13' 2' PT#113 METAL RAIL

CONC HCR TO CONCOURSE

SHRUBS

UNDERGROUND GARAGE

STAIRS TO CONCOURSE

N.T.S.

MAGNETIC NORTH SUBTRACT 14° FOR TRUE NORTH.

DE YOUNG MUSEUM

OBSTRUCTIONS

TREE

TREE

TREE

TREE

SUTRO TWR

Station ID: 113

STATION RECOVERY & OBSTRUCTION FORM

STATION ID: 114 **Set by:** GP, BS, SB **Date:** 6/21/13

Monument Desc: 2" DOMED BRASS DISC

Station Description: PUNCHED & STAMPED "CCSF SURVEY MONUMENT
L.S. 6914 Δ."

SET IN SOUTHERLY CONCRETE SIDEWALK MIDBLOCK OF ORTEGA, BETWEEN
27TH AND 28TH AVENUES.

ACROSS FROM ♀ STAIRS TO ENTRANCE OF #2024 ORTEGA.

4.5' SOUTH OF FACE OF CURB

67' EAST OF THE EAST FACE OF 2' WIDE x 4' LONG x 4' HIGH "AT&T"
VAULT CABINET.

FIELD SKETCH

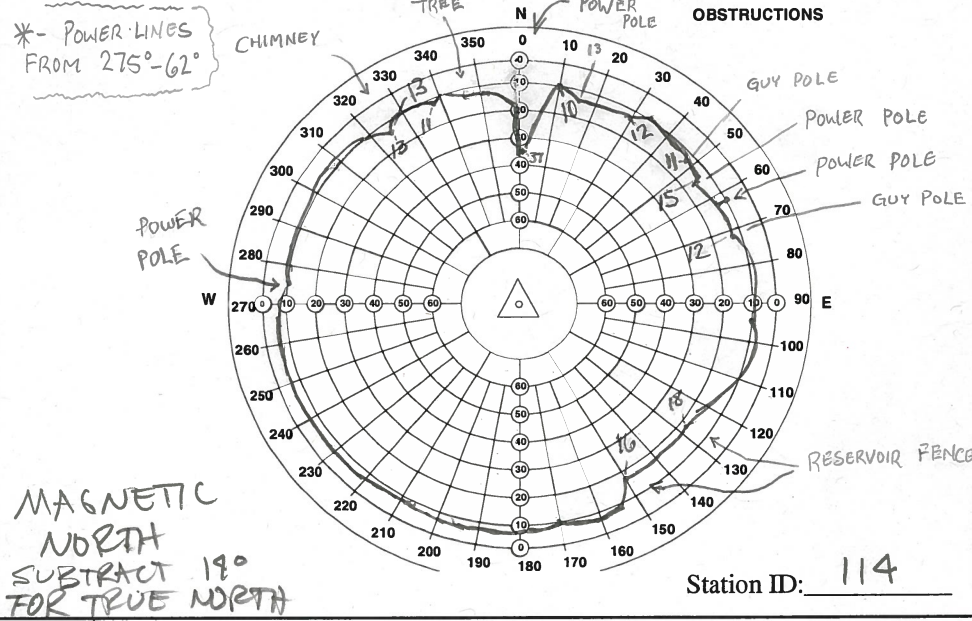
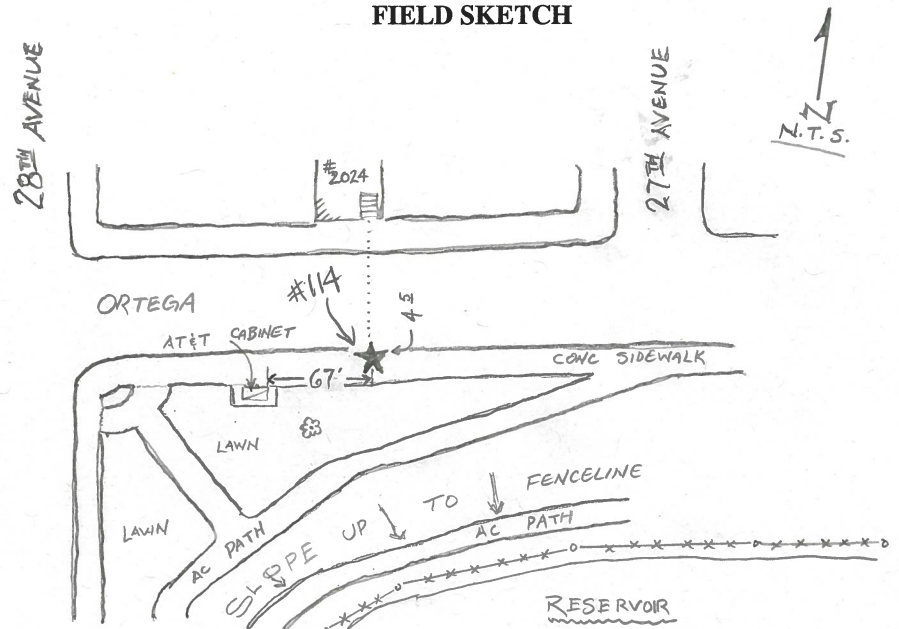

Travel Time: _____ **Pack Distance:** _____

Public | Private | Locked Gate | Parking Adjacent | Offroad | 4W Drive

Key Required: _____ **Contact/Permission:** _____

Other Information

MERCED MANOR RESERVOIR

City & County of San Francisco

STATION RECOVERY & OBSTRUCTION FORM	
STATION ID: 115	Set by: BS, SB, GP Date: 6/21/13
Monument Desc: 2" DOMED BRASS DISC	
Station Description: PUNCHED & STAMPED "CCSF SURVEY MONUMENT"	
L.S. 6914 Δ."	
SET IN CONCRETE LANDING OF EAST STAIRCASE LEADING TO TOP OF MERCED MANOR RESERVOIR, ON 22 ND AVENUE MIDBLOCK, BETWEEN SLOAT BLVD. AND OCEAN AVENUE.	
IN THE CENTER OF THE UPPER MOST LANDING OF THE SOUTHERLY OF THE 2 SETS OF STAIRS.	
OPPOSITE #2964 22 ND AVENUE.	
5.4' EAST OF THE EAST EDGE OF THE RESERVOIR ROOF.	
4.4' NORTH OF THE FACE OF THE TOP STEP AT THE SOUTH SIDE OF LANDING.	
Travel Time:	Pack Distance:
Public Private Locked Gate Parking Adjacent Offroad 4W Drive	
Key Required:	Contact/Permission:
Other Information	

FIELD SKETCH

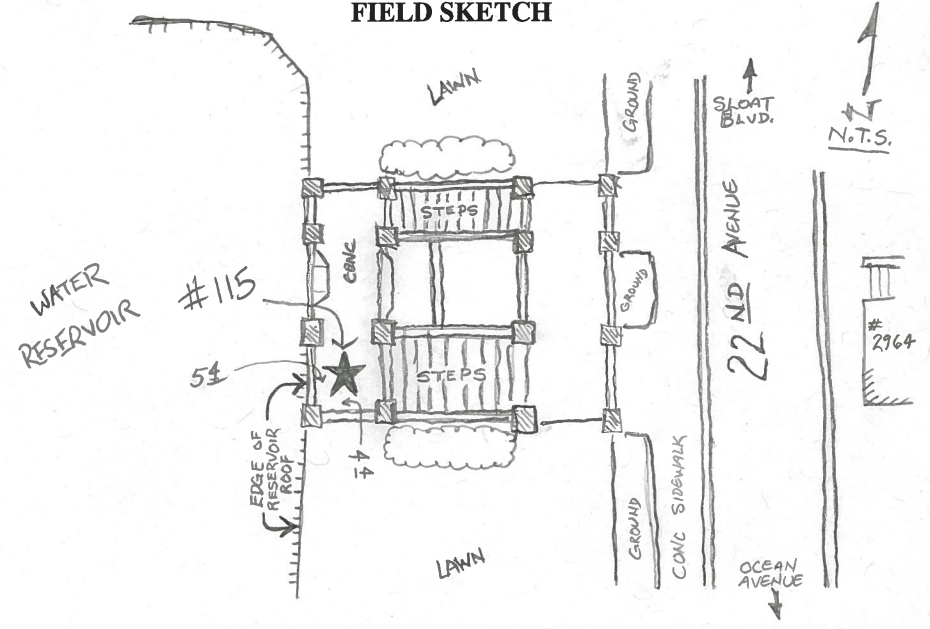

MAGNETIC NORTH
SUBTRACT
14° FOR
TRUE NORTH

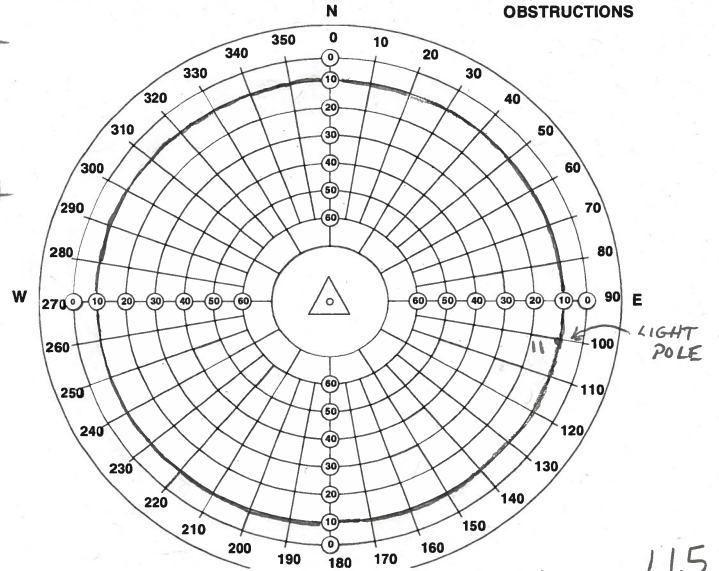

Station ID: 115

MCLAREN PARK

City & County of San Francisco

STATION RECOVERY & OBSTRUCTION FORM

STATION ID: 117 Set by: BS, SB, RA Date: 6-14-13

Monument Desc: 2" DOMED BRASS DISK

Station Description: SET PUNCHED & STAMPED 2"

DOMED BRASS DISK "CCSF SURVEY MONUMENT
L.S. 6914" IN THE ELY SIDE OF A 1.5' THICK
BY 2' TALL CIRC. CONC. WALL PLANTER,
SW'LY OF OF THE VIEWPOINT PARKING LOT
@ MANSELL ST & VISITACION AVE IN
MCLAREN PARK, ABOUT 140' S'LY OF THE
N'LY ENT. GATE ON MANSELL ST.

Travel Time: Pack Distance:
Public | Private | Locked Gate | Parking Adjacent | Offroad | 4W Drive
Key Required: Contact/Permission:
Other Information

FIELD SKETCH

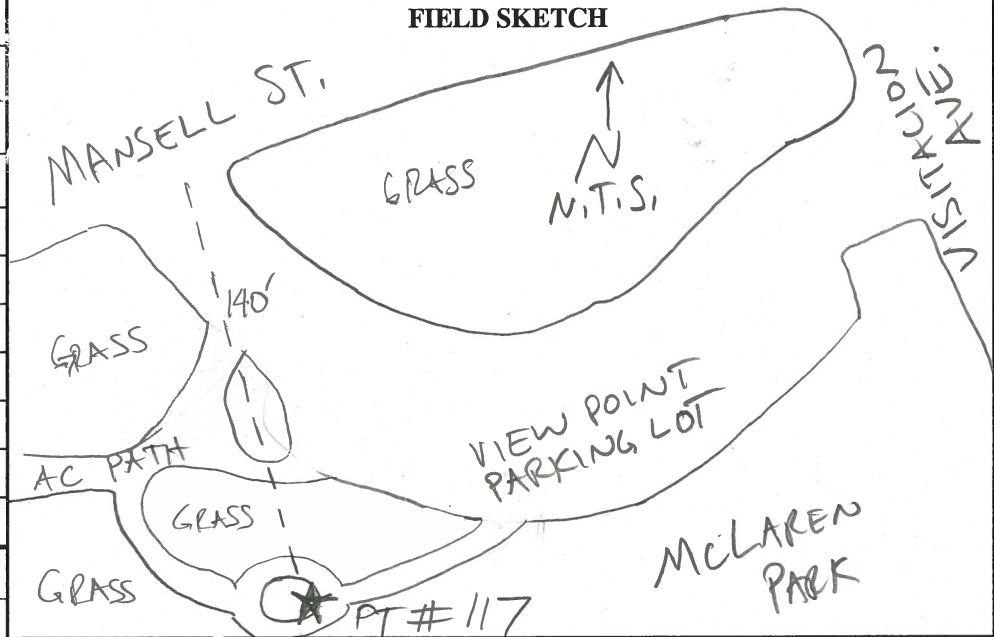

MAGNETIC
NORTH
SUBTRACT 19°
FOR TRUE
NORTH

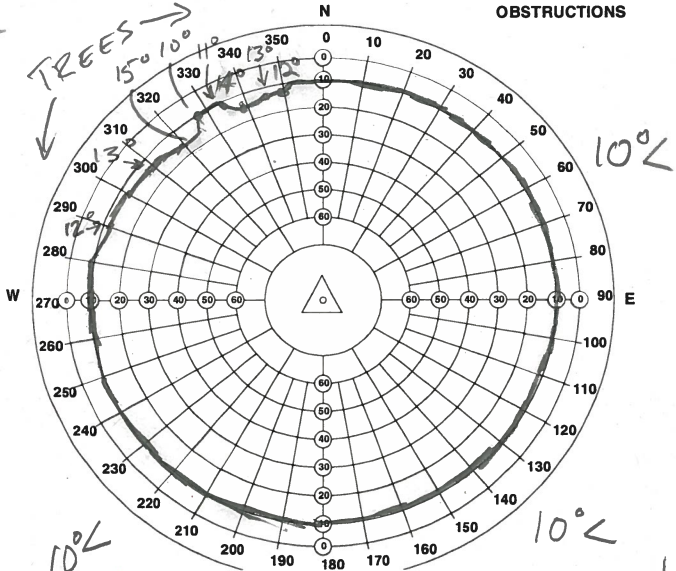

Station ID: 117

STATION RECOVERY & OBSTRUCTION FORM

STATION ID: 118 **Set by:** JTM, GP **Date:** 7.9.13

Monument Desc: 2" DOMED BRASS DISK STAMPED "CCSF SURVEY MONUMENT L.S. 6914 Δ" WITH CENTER PUNCH.

Station Description: IN THE CITY AND COUNTY OF SAN FRANCISCO.
AT BERNAL HEIGHTS.

SET IN NORTHERLY CONCRETE SIDEWALK OF BERNAL HEIGHTS BLVD AT
THE INTERSECTION OF CARVER ST.

AT THE PROD OF EASTERLY CURB FACE OF CARVER ST.

24.4' EASTERLY OF CENTERLINE OF HANDICAP RAMP.

2.75' NORTHERLY OF NORTHERLY CURB FACE OF BERNAL
HEIGHTS BLVD.

Travel Time: **Pack Distance:**

Public | Private | Locked Gate | Parking Adjacent | Offroad | 4W Drive

Key Required: **Contact/Permission:**

Other Information

FIELD SKETCH

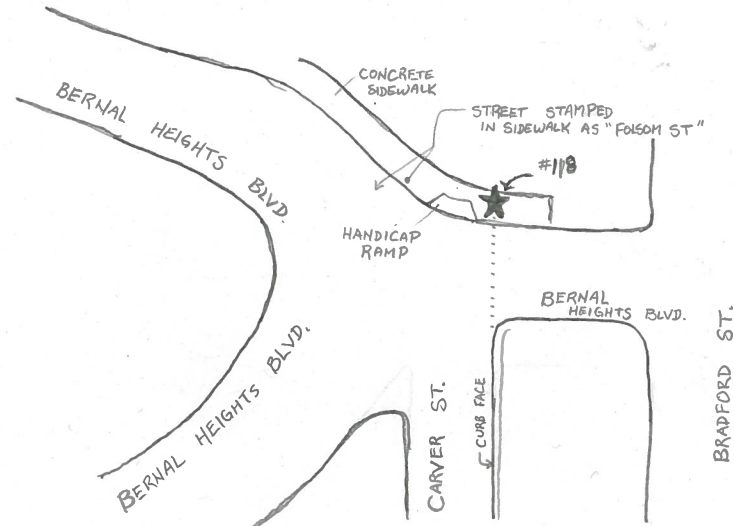

MAGNETIC
NORTH
SUBTRACT
14° FOR
TRUE
NORTH

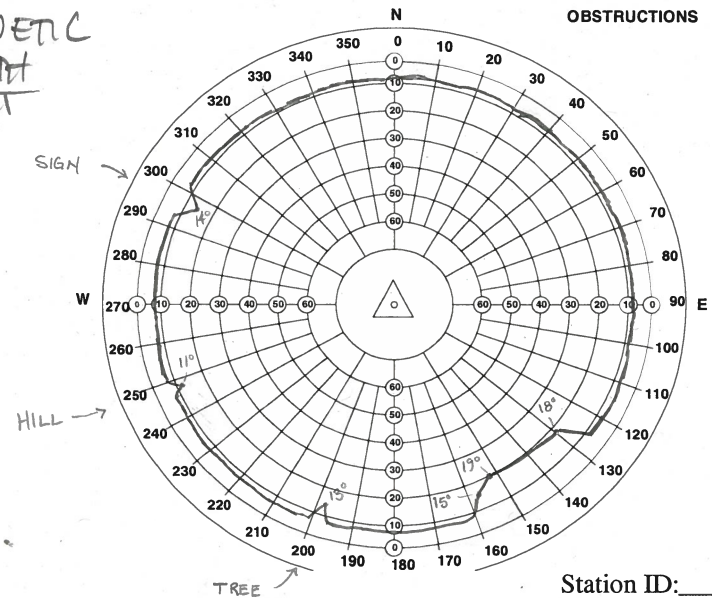

Station ID: 118

