

HALLIDIE PLAZA

Accessibility Improvements

CONCEPT DESIGNS PRESENTATION
April 2026

AGENDA

- Welcome and Introductions
- Project Background
- Existing Conditions
- Review DRAFT Design Concepts
- Open Q/A Session - 15 minutes
- Small Group Discussion

PROJECT PARTNERS:



SAN FRANCISCO HUMAN SERVICES AGENCY
**Department of Disability
and Aging Services**

Office on
Disability and
Accessibility

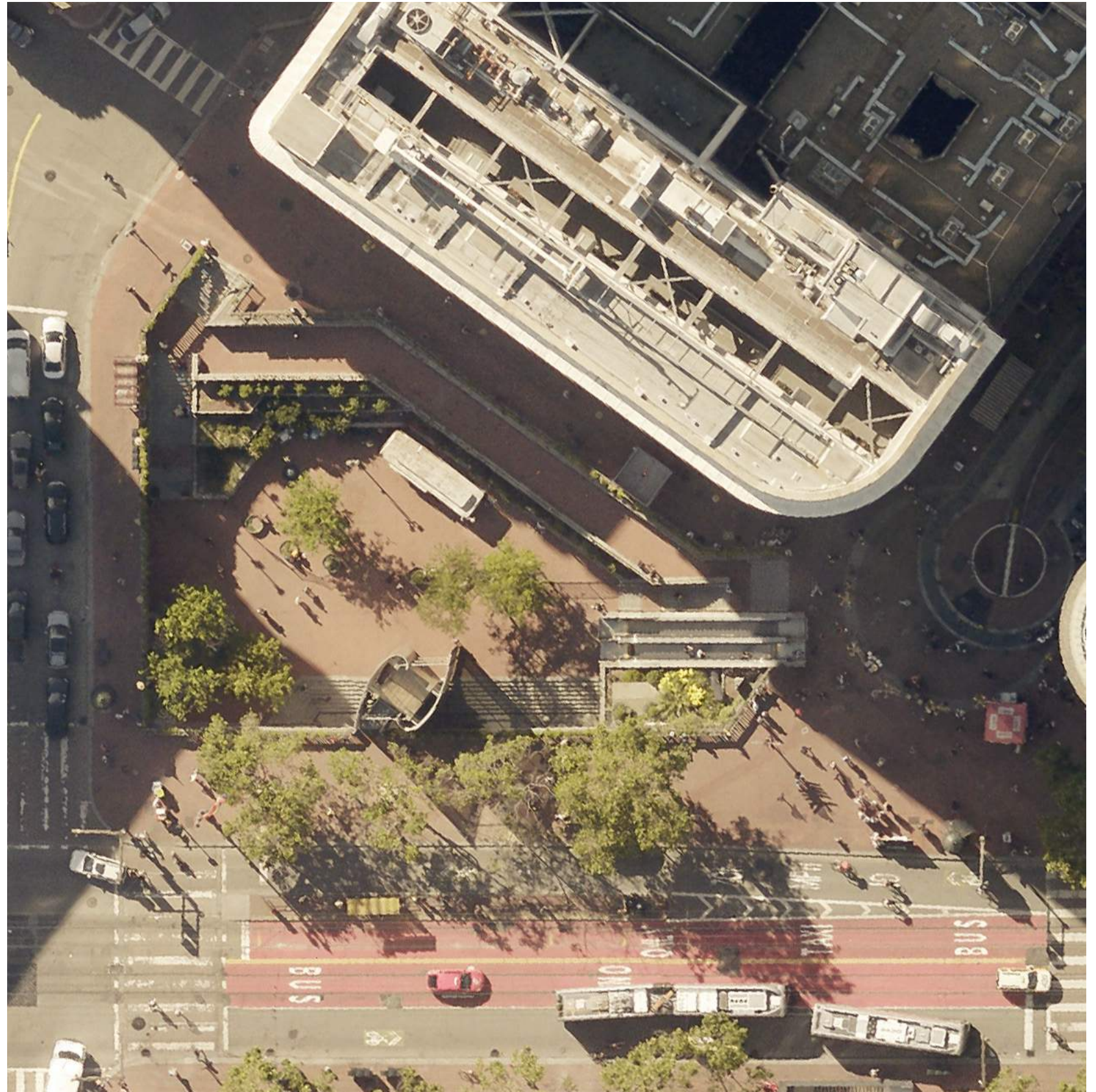

Project Design + Development
Bureau of Landscape Architecture

OFFICE ON DISABILITY AND ACCESSIBILITY (ODA)

- Welcome and Housekeeping
- Acknowledging the Advocacy of the Disability Community
- Ice Breaker



Digital portrait by Jen White-Johnson.

[Photo of Alice Wong, an Asian American woman with honey blonde hair. She is in a wheelchair and there is a tracheostomy at her neck connected to a ventilator. She is wearing a silky multicolored shirt and a bold red lip color. She is looking intently at the camera with the heat of a thousand suns. Behind her are red and purple flowers with a red circle in the background framing her face like a warm sun. The background of the portrait is purple.]

PROJECT FUNDING & SCHEDULE:

FUNDING

- November 2024 Prop B Ballot Measure – Healthy, Safe and Vibrant San Francisco Bond - \$390M
- \$41M is dedicated to “improvements to civic spaces to provide welcoming gathering spaces for the public”.
- Hallidie Plaza was specifically included in the bond measure under this category and is receiving a total of \$9M for design & construction.
- The San Francisco Office on Disability and Accessibility (ODA) and San Francisco Curb Ramp Program partnered to submit a Capital Planning Project Request to bring accessibility improvements to Hallidie Plaza. Special thanks to ODA for their support and unwavering dedication to securing project funding.



PROPOSED SCHEDULE

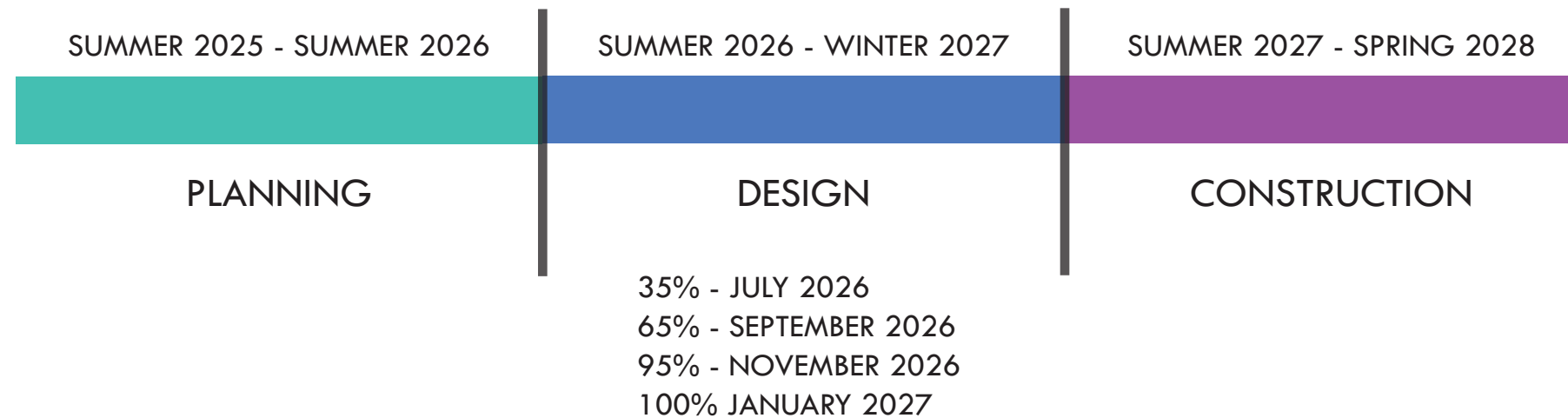

GOALS / OBJECTIVES

1. Recognize Hallidie Plaza as a main entry to San Francisco
2. Design for a welcoming, safe and vibrant public space
3. Improve accessibility and access to the plaza from street level and Muni/Bart stations
4. Ensure the plaza remains sociable and flexible in accommodating programs/activities
5. Consider operations and maintenance as it relates to design changes in plaza
6. Honor the legacy of the plaza design and ensure its integrity remains alongside new accessible features



HISTORY

- Opened in 1973
- Named after Andrew Smith Hallidie, who developed the world's first cable car system.
- Designed by Lawrence Halprin, John Carl Warnecke, and Mario Ciampi in modernist/Brutalist architectural style.
- Key BART/Muni Powell St station was one of the first stations along Market St and serves as a front doorstep to San Francisco, near attractions and shopping districts.
- Sunken Plaza is 20' below street level, with terracing, and brick, bronze and granite elements.

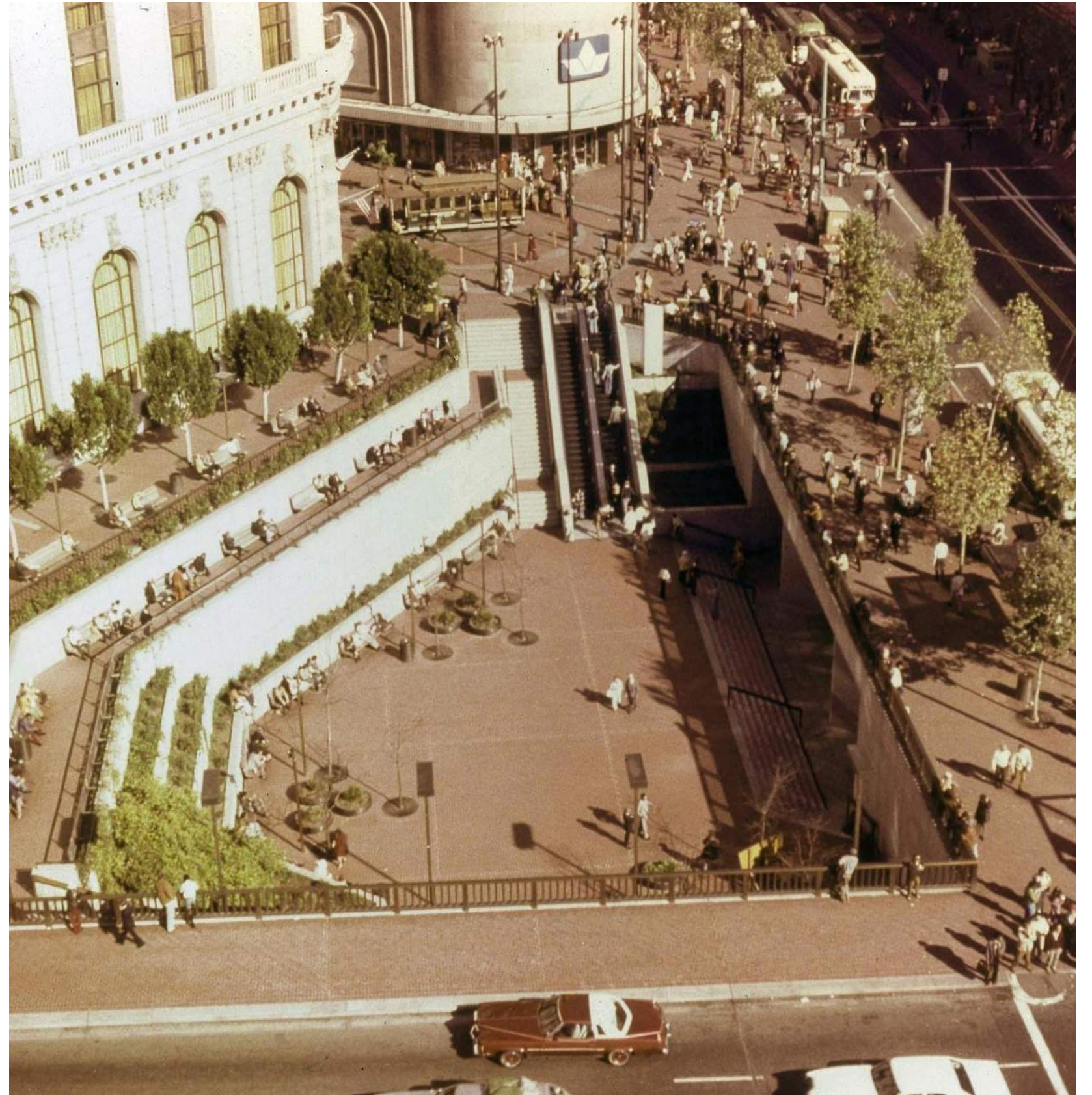

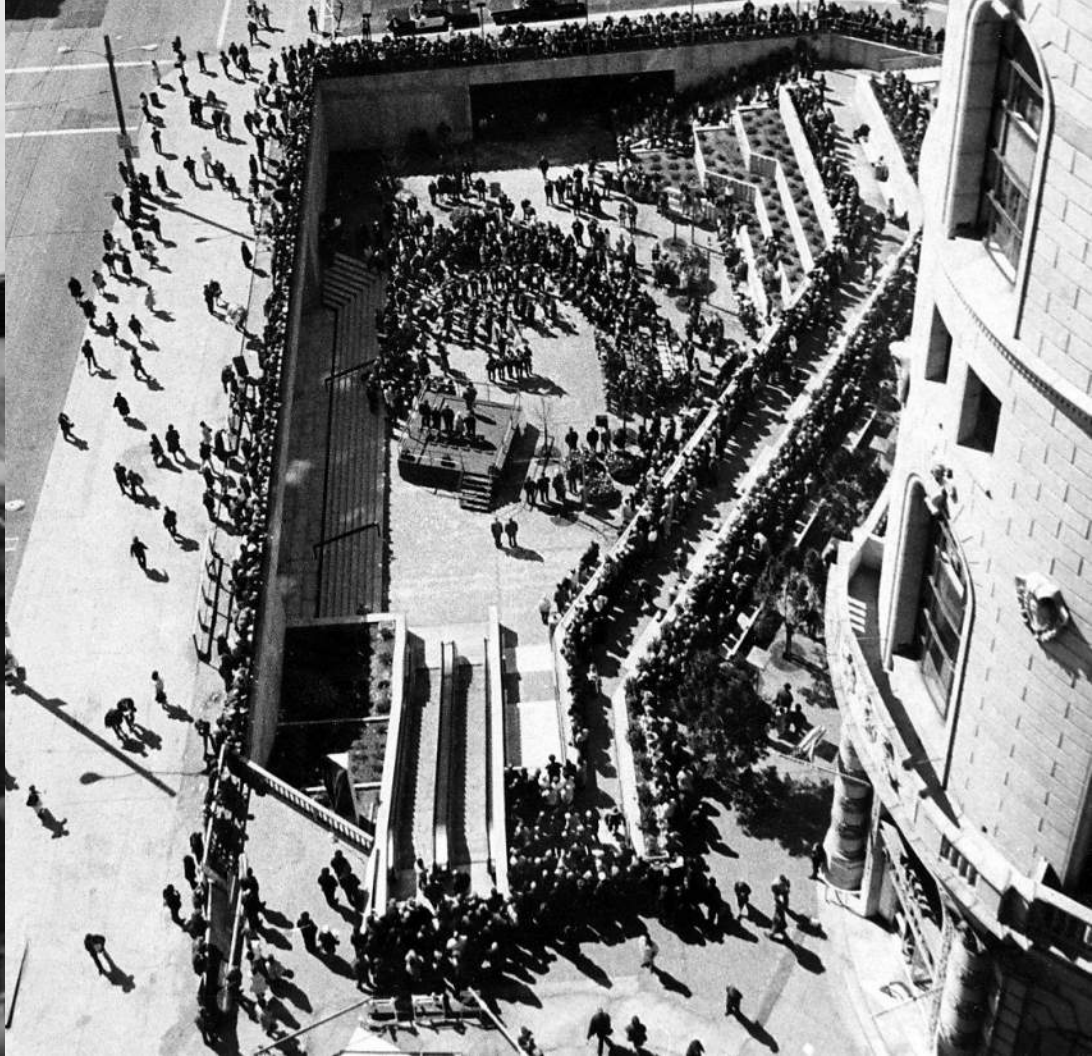



SITE ACCESS

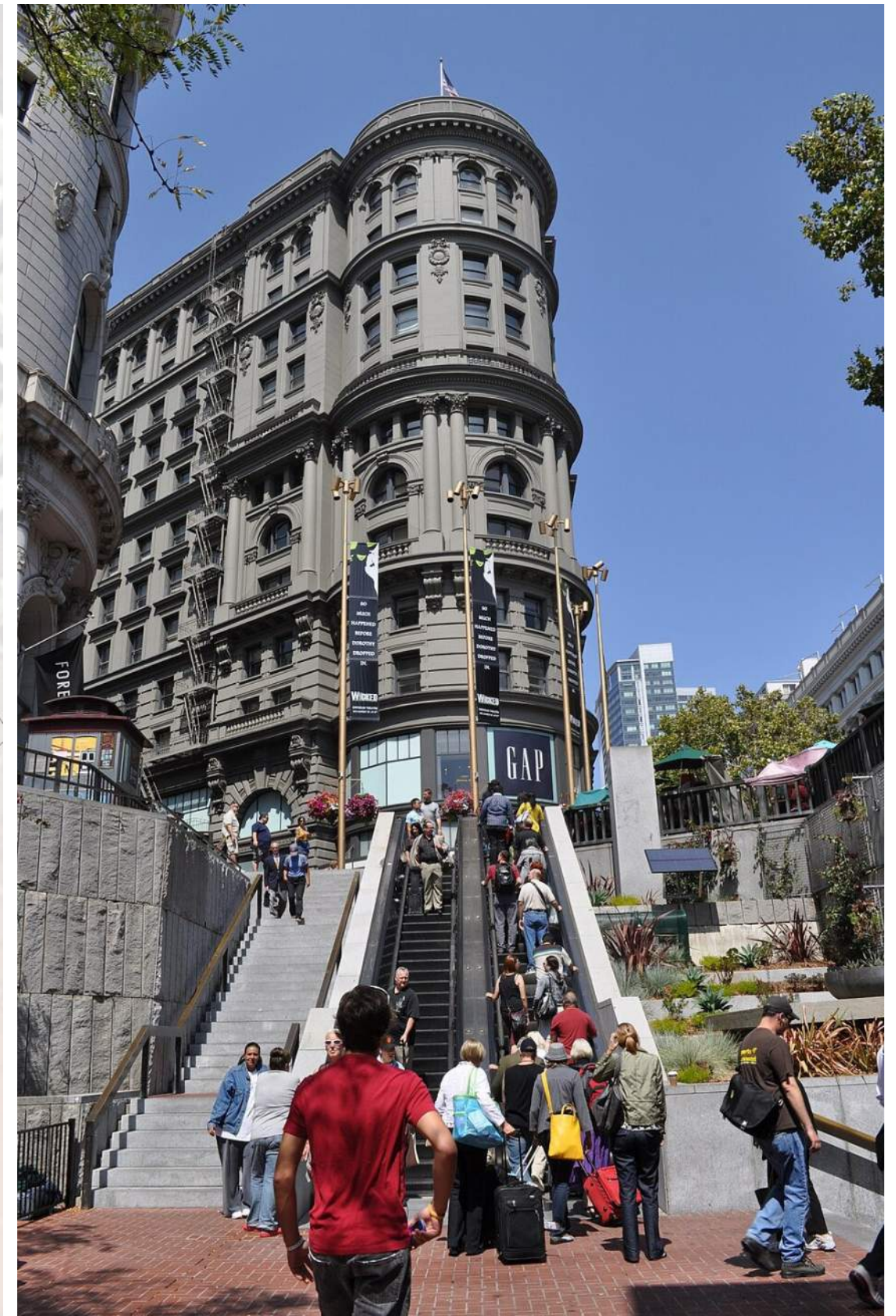
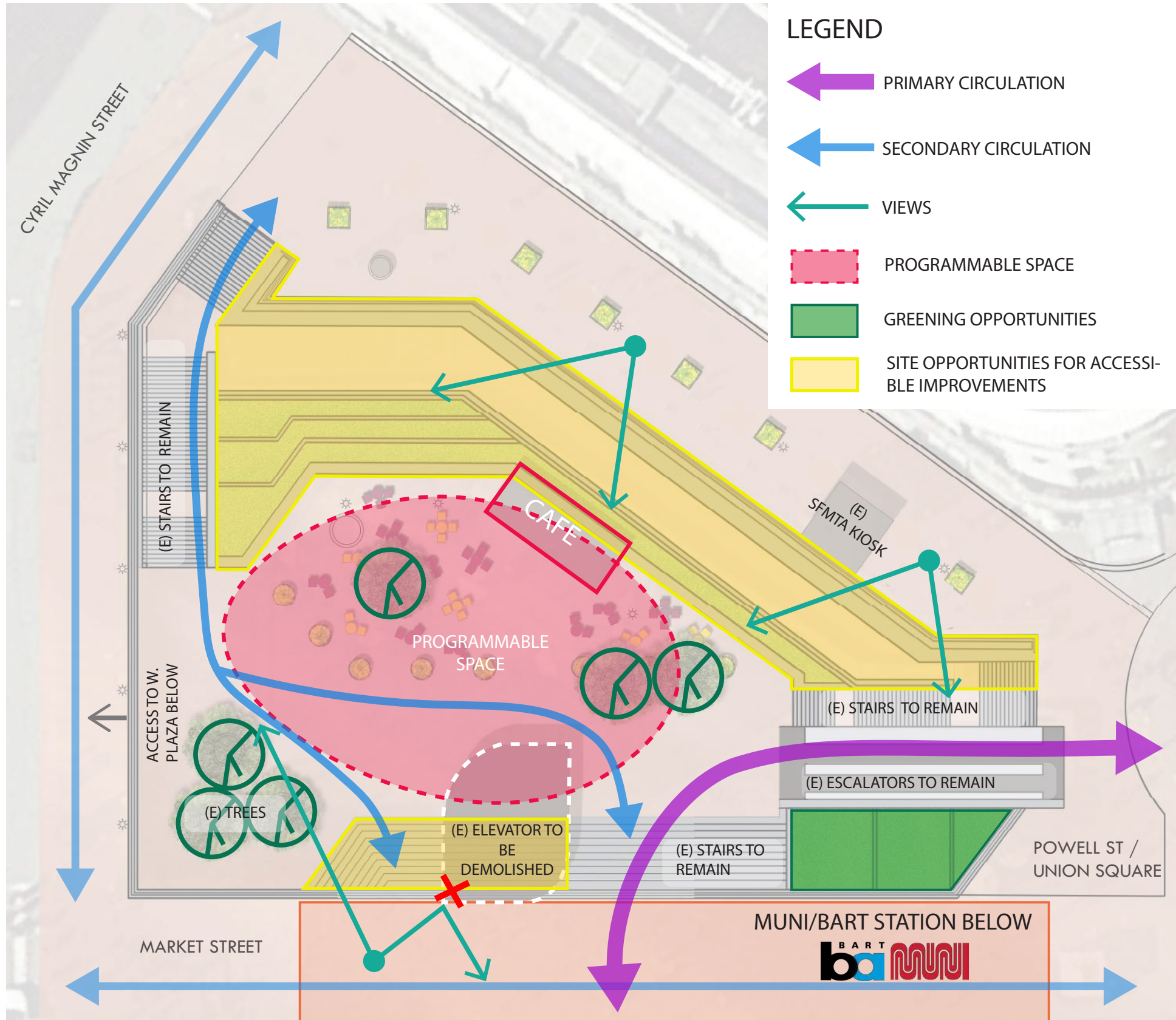

SITE ACCESS

WALKWAY AT 5%: 448 LF
RAMP AT 7.5%: 305 LF

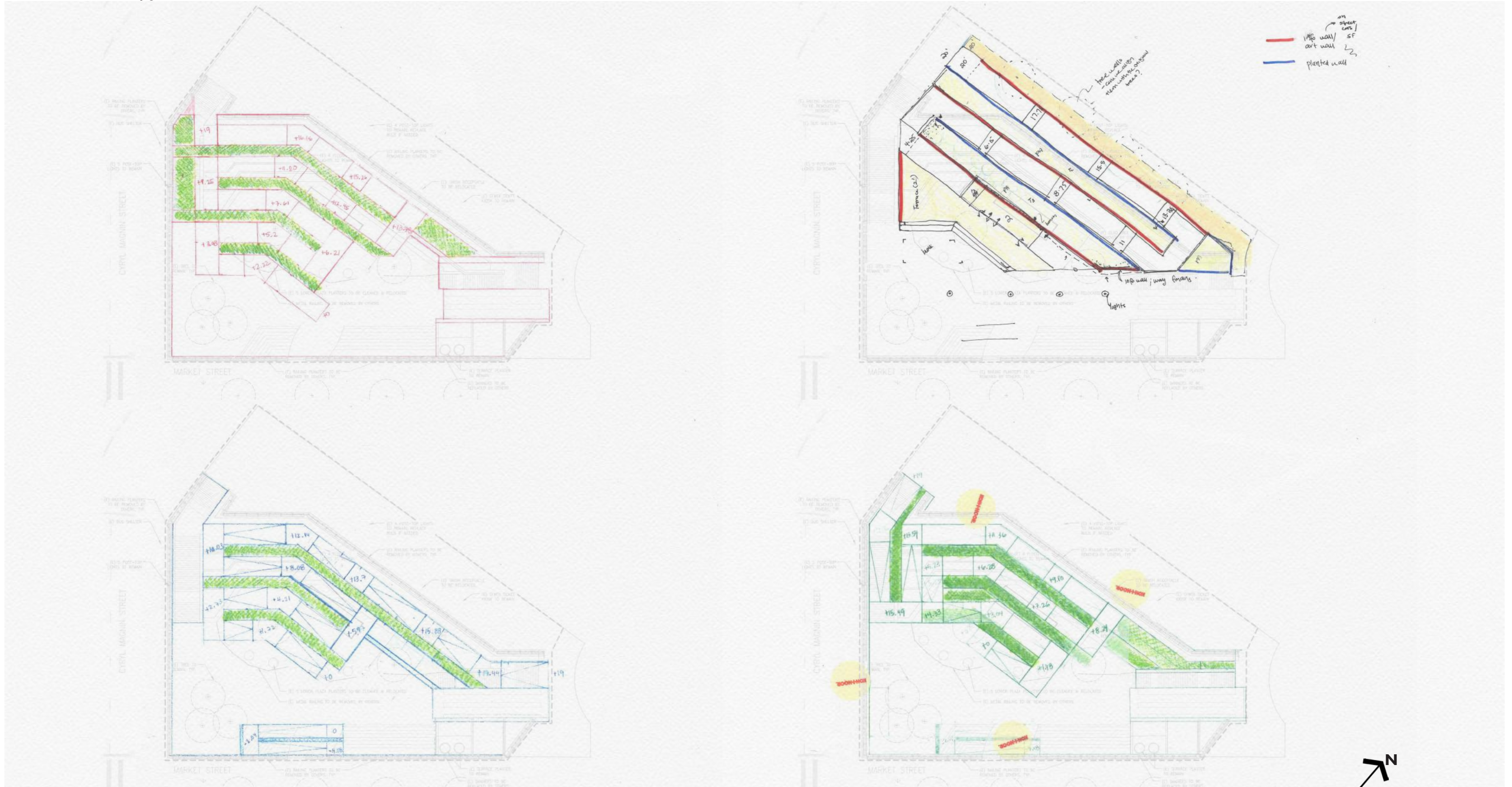



BROOKLYN BOTANIC GARDEN

DESIGN OPTIONS



DESIGN DESCRIPTION:

- DESIGN OPTION A MAXIMIZES PLANTING AREA SPACE.
- 8' WIDE MAIN RAMP WILL CONNECT THE UPPER TERRACE TO THE LOWER TERRACE. SECONDARY RAMP WILL CONNECT THE LOWER TERRACE TO THE MUNI/BART STATIONS.
- RAISED PLANTING AREAS WILL INCLUDE LOW MAINTENANCE, LOW WATER USE, AND CLIMATE APPROPRIATE SPECIES.
- NEW SPECIAL PAVING WILL COMPLEMENT POWELL STREET PROJECT.
- INFILL STREET TREES AND SEATING ON THE UPPER TERRACE WILL SUPPORT A MORE WELCOMING PLAZA.
- NEW LIGHTING FIXTURES ON HANDRAILS AND TERRACED WALLS.
- NEW PEDESTRIAN LIGHTING AND MOVEABLE SEATING ON LOWER TERRACE FOR FLEXIBLE PROGRAMMING.
- OPPORTUNITIES FOR INTERPRETATIVE SIGNAGE AND WAYFINDING.

NEW TREES

TERRACED WALLS WITH LIGHTS

NEW PLANTING AREAS

NEW HANDRAIL & GUARDRAIL

EXISTING PLAZA OUTLINE

NEW RAMP

MOVEABLE TABLES & CHAIRS

NEW PEDESTRIAN LIGHTING

NEW PAVING

CYRIL MAGNIN STREET

POWELL STREET

TUNNEL

NEW RAMP TO MUNI/BART STATIONS
POTENTIAL LOCATION FOR FUTURE ELEVATOR

STORAGE

**PLAN
DESIGN OPTION A**

MARKET STREET

ZONE

MPH

10

SCALE: 1" = 20'-0"

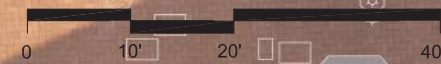



AERIAL VIEW
DESIGN OPTION A



cable car tickets

BANK OF AMERICA

Market Street
Powell Street
Streetcar F-Line
Cable Car Turnaround
Union Square Park
Maiden Lane

**HALLIDIE
PLAZA**

NOTICE

THIS AREA
MAY BE
SUBJECT TO
CLOSED RECORDING

EXISTING VIEW FROM STATION



PERSPECTIVE VIEW FROM STATION
DESIGN OPTION A



PERSPECTIVE VIEW FROM STAIRS
DESIGN OPTION A

DESIGN OPTION A

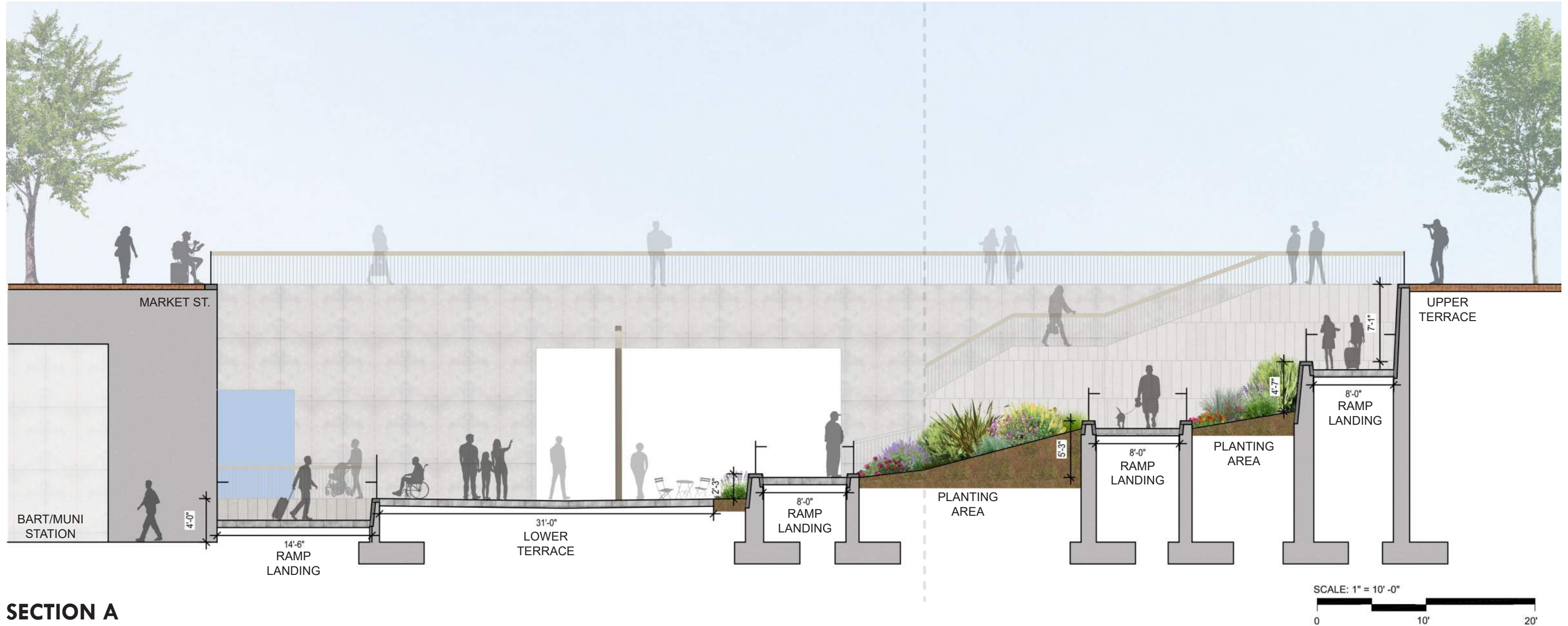
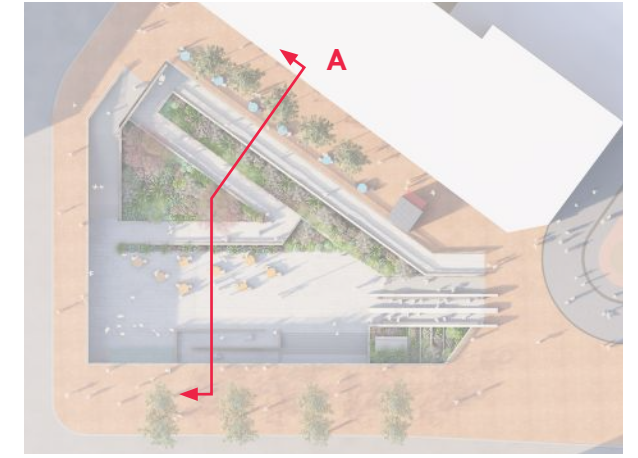

SECTION A



DESIGN OPTION A

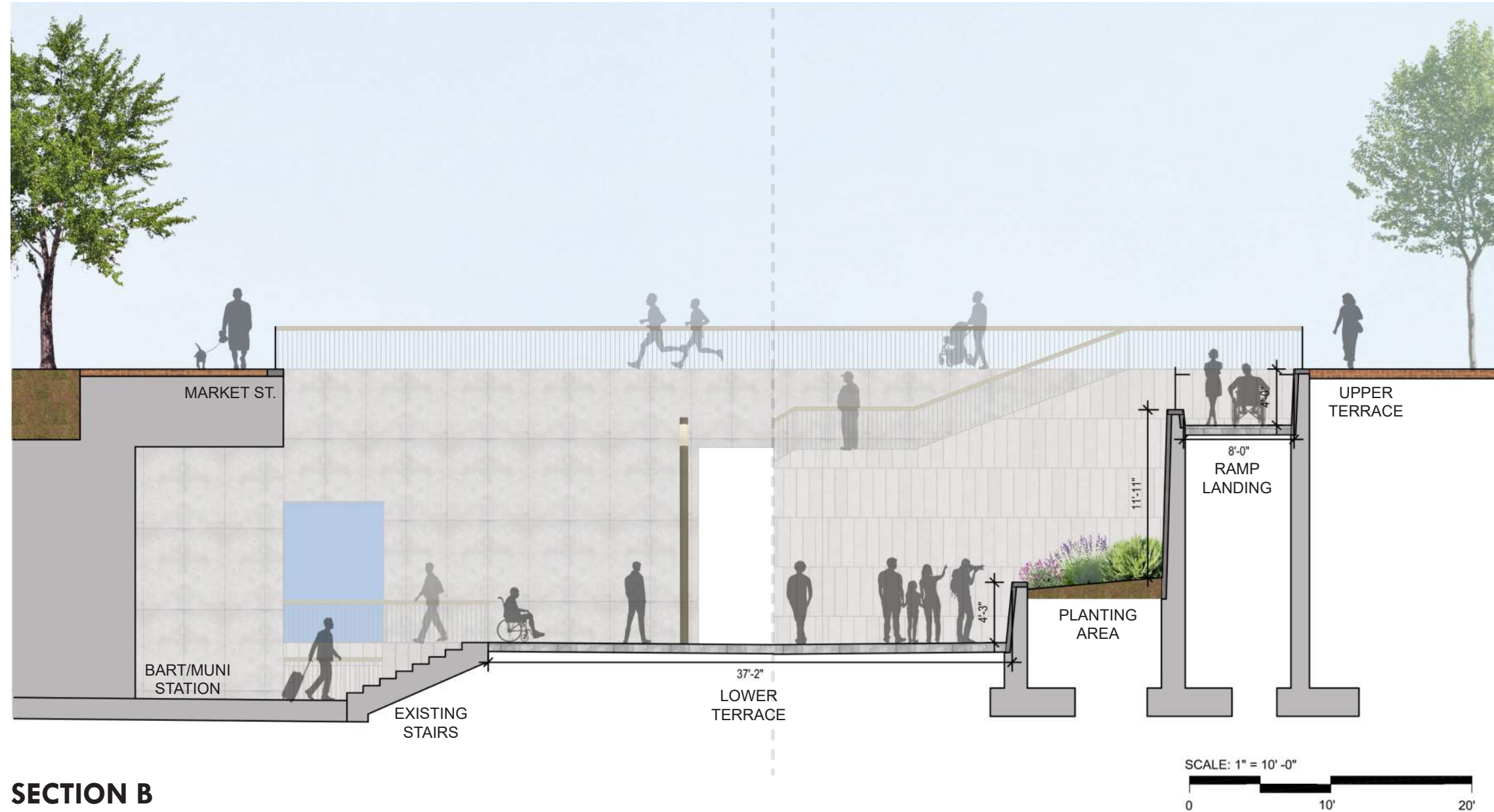
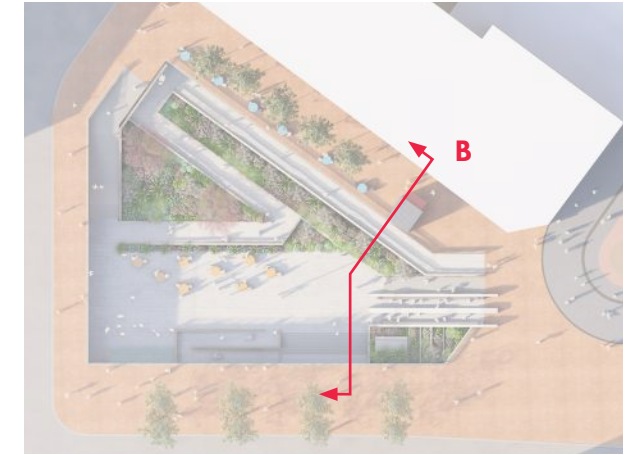

SECTION B



DESIGN DESCRIPTION:

- DESIGN OPTION B MAXIMIZES THE LOWER TERRACE SPACE FOR FLEXIBLE PROGRAMMING.
- 8' WIDE MAIN RAMP WILL CONNECT THE UPPER TERRACE TO THE LOWER TERRACE. SECONDARY RAMP WILL CONNECT THE LOWER TERRACE TO THE MUNI/BART STATIONS.
- RAISED PLANTING AREAS WILL INCLUDE LOW MAINTENANCE, LOW WATER USE, AND CLIMATE APPROPRIATE SPECIES.
- NEW SPECIAL PAVING WILL COMPLEMENT POWELL STREET PROJECT.
- INFILL STREET TREES AND SEATING ON THE UPPER TERRACE WILL SUPPORT A MORE WELCOMING PLAZA.
- SEATING AREA AT THE LOWER TERRACE WILL PROVIDE A PLACE TO MEET, GREET AND GATHER FOR SMALL AND LARGE GROUPS.
- NEW LIGHTING FIXTURES ON HANDRAILS, SEATING STEPS AND TERRACED WALLS.
- NEW PEDESTRIAN LIGHTING AND MOVEABLE SEATING ON LOWER TERRACE FOR FLEXIBLE PROGRAMMING.
- OPPORTUNITIES FOR INTERPRETATIVE SIGNAGE AND WAYFINDING.

NEW TREES

TERRACED WALLS WITH LIGHTS

NEW PLANTING AREAS

NEW HANDRAIL & GUARDRAIL

EXISTING PLAZA OUTLINE

NEW RAMP

MOVEABLE TABLES & CHAIRS

NEW PEDESTRIAN LIGHTING

SEATING STEPS

NEW PAVING

CYRIL MAGNIN STREET

POWELL STREET

TUNNEL

NEW RAMP TO MUNI/BART STATIONS

POTENTIAL LOCATION FOR FUTURE ELEVATOR

STORAGE

PLAN

DESIGN OPTION B

MARKET STREET

ZONE

MPH

10

SCALE: 1" = 20'-0"

0 10 20 40





AERIAL VIEW
DESIGN OPTION B



cable car tickets

Market Street
Powell Street
Streetcar F-Line
Cable Car Turnaround
Union Square Park
Maiden Lane

**HALLIDIE
PLAZA**

EXISTING VIEW FROM STATION



PERSPECTIVE VIEW FROM STATION
DESIGN OPTION B



PERSPECTIVE VIEW FROM STAIRS
DESIGN OPTION B

DESIGN OPTION B

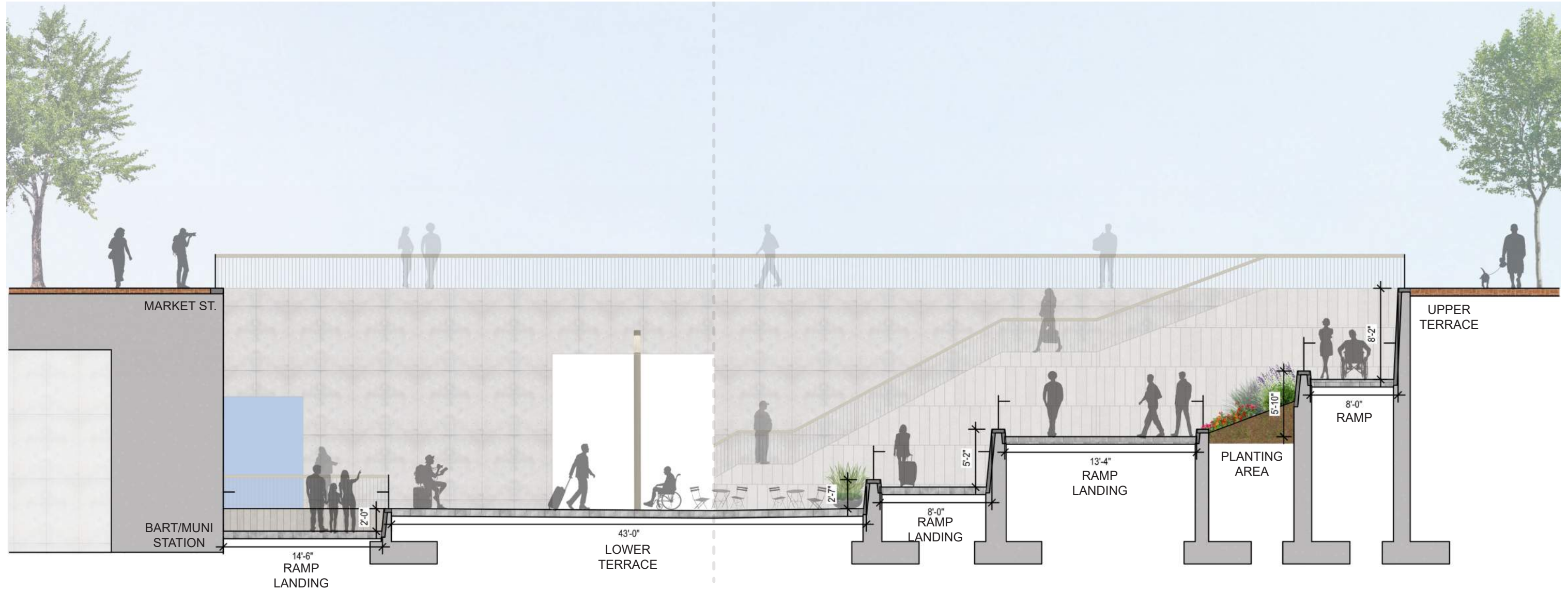
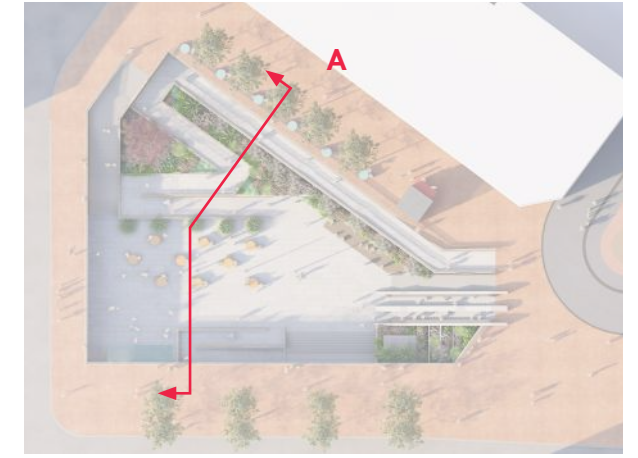

SECTION A



DESIGN OPTION B

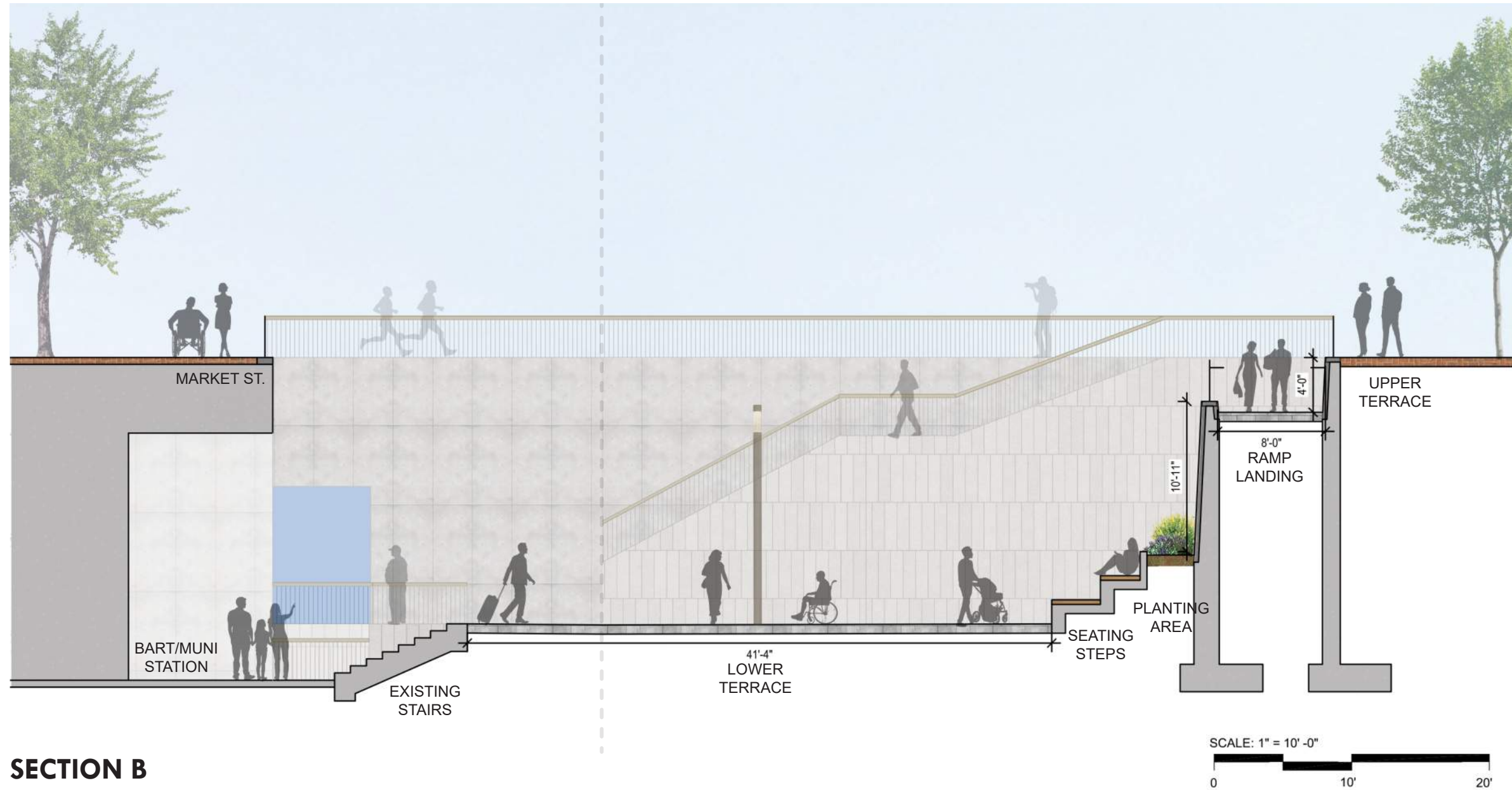
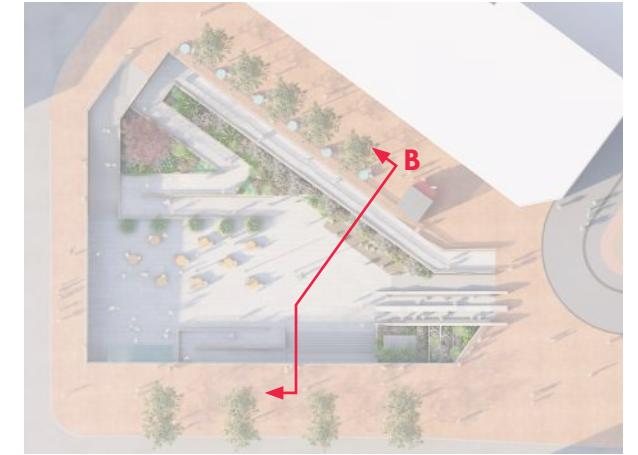

SECTION B



MATERIALS/INSPIRATION

SPECIAL PAVING:



CONCRETE PAVING



PAVERS



POWELL STREET PROJECT

RAILING:



BRONZE GUARDRAILS & HANDRAILS



PLANTING:



RAISED PLANTING AREAS BETWEEN MAIN RAMP

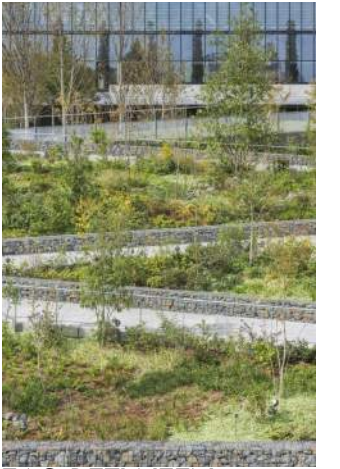

FURNISHINGS:



MOVEABLE TABLES & CHAIRS



MOBILE VENDOR KIOSK

SIGNAGE/ INTERPRETIVE OPPORTUNITIES:



INTERPRETIVE FEATURES

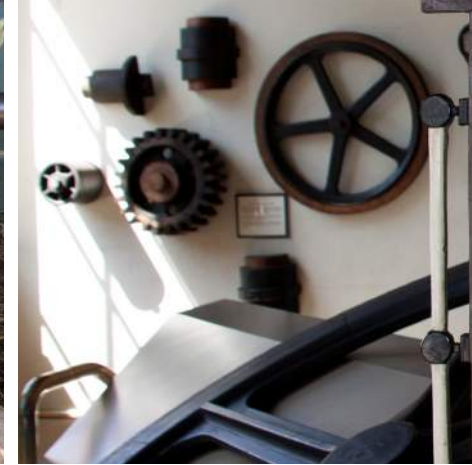

INTERPRETIVE FEATURES



WAYFINDING



WAYFINDING

LIGHTING:



FEATURE WALL WITH LIGHTING

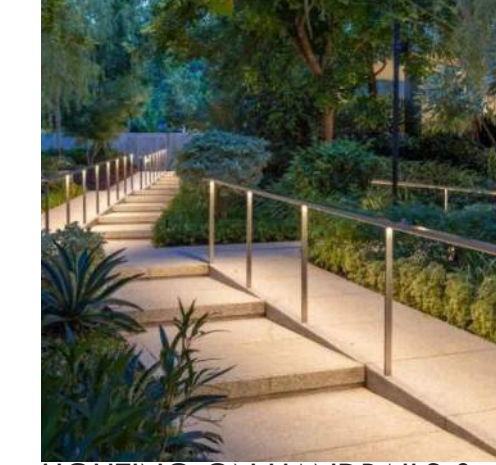

LIGHTING ON HANDRAILS & GUARDRAILS



SEATING STEPS WITH LIGHTING



PEDESTRIAN SCALE LIGHTING

WALLS:



EXISTING GRANITE WALLS





DESIGN OPTION A



DESIGN OPTION B



DESIGN OPTION A



DESIGN OPTION B

NEXT STEPS:

- Confirm utility conflicts and further engineering coordination
- Validate design options against funding available
- Incorporate feedback into (1) design concept
- Community Meeting #3 - Summer 2026

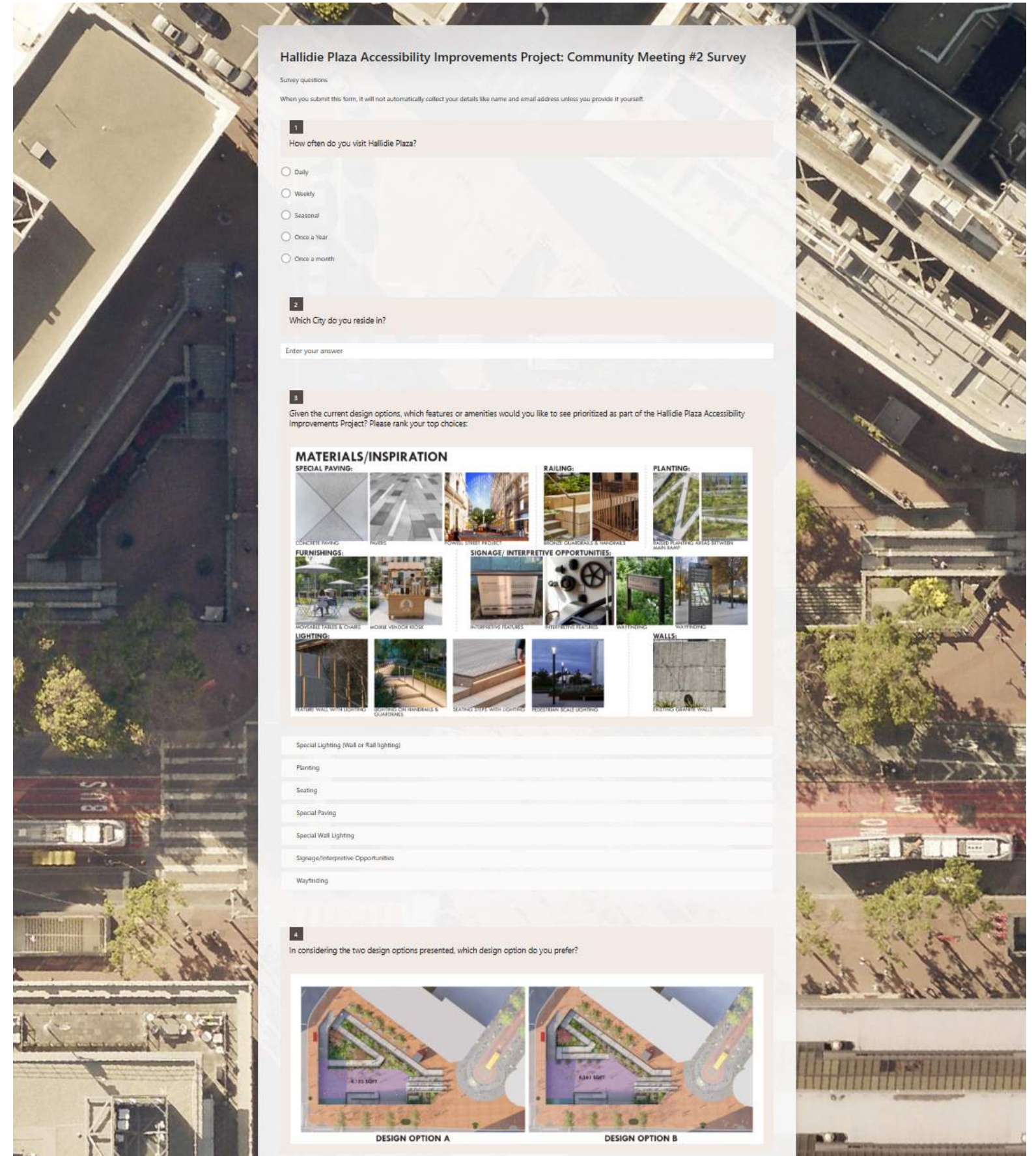

PROJECT WEBSITE:

<https://sfpublicworks.org/HallidiePlaza>

CONTACT INFORMATION:

Project Manager: Anastastia.Haddad@sfdpw.org

SURVEY:

Fill out the survey by **MAY 8TH**:

<https://forms.office.com/g/iBACJvDr5B>



SAN FRANCISCO HUMAN SERVICES AGENCY
**Department of Disability
and Aging Services**

Office on
Disability and
Accessibility



Project Design + Development
Bureau of Landscape Architecture

THANK YOU

