



OCEAN AVENUE CORRIDOR DESIGN PROJECT

PUBLIC WORKSHOP #1 | MARCH 12, 2014

SAN FRANCISCO
PLANNING DEPARTMENT



Meeting Outline

- 6:00-6:10pm
Arrive & Sign-in
- 6:10 – 6:30pm
Presentation
- 6:30-7:40pm
Small group activities (20 minute per station)
- 7:45-8pm
Next Steps

Today's Presentation

- Welcome & Introductions
- Background
- Ocean Avenue Today
- Future Projects
- Next Steps
- Title VI

Goals of Tonight's Workshop

- Understand what you like and dislike about Ocean Avenue today
- Share ideas about ways to improve and beautify the Commercial Corridor
- Get input on your route and experience along Ocean Avenue from Phelan to San Jose

Project Overview

OCEAN AVENUE CORRIDOR DESIGN PROJECT

Project Boundary

Ocean Avenue Corridor Design Project



Near Term Construction Project

PROJECT BOUNDARY:

- Manor Drive to Phelan Avenue

FUNDING :

- Road Repaving and Streets Safety Bond (Prop B)

2011 Road Repaving and Street Safety Bond

Program	Total Bond (\$ in Millions)
Street Repaving & Reconstruction	\$148
Sidewalk Accessibility Improvements	\$22
Street Structures Rehabilitation	\$7
Streetscape, Pedestrian & Bicycle Safety Improvements	\$50
Transit Signal Infrastructure	\$20

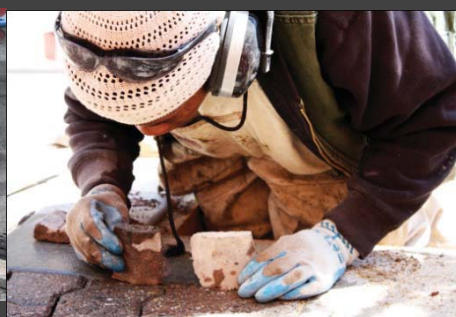

OCEAN AVENUE CORRIDOR DESIGN PROJECT

Streetscape Projects Map

2011 Road Repaving and Street Safety Bond
Streetscape, Pedestrian and Bicycle Safety Improvements

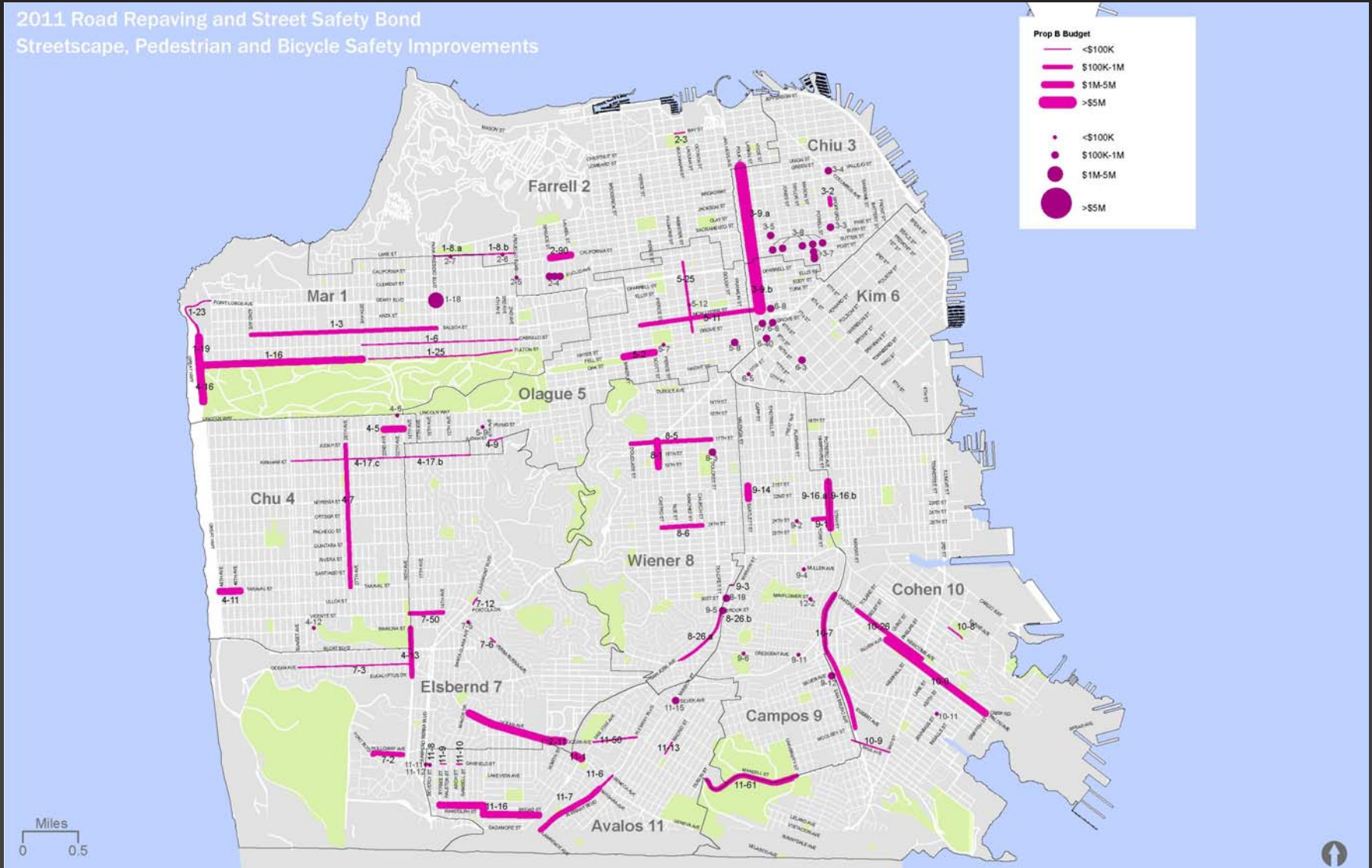

OCEAN AVENUE CORRIDOR DESIGN PROJECT

Near Term Construction Project

TIMELINE:

- Planning: March 2014 to July 2014:
 - Site Walk: March 8, 2014
 - **Public Workshop #1: March 12, 2014**
 - Public Workshop #2: May 2014
 - Public Workshop #3: July 2014
- Design/Bid: Summer 2014 to Winter 2014
- Construction: Winter 2014 to Summer 2015

Longer Term Design Project

PROJECT BOUNDARY:

- Phelan Avenue to San Jose Avenue

FUNDING :

- Federal transportation funds for planning in Priority Development Areas (PDAs)

TIMELINE:

- Planning: January 2014 to August 2015
 - Existing Conditions Analysis
 - Develop Design Options
 - Detailed Design, Cost Estimate and Phasing Plan

Ocean Avenue Today

Ocean Avenue Today: Street Characteristics



Ocean Avenue Today: 2005 K-Line Rail Replacement and Ocean Avenue Improvements, from Junipero Serra to I-280.



OCEAN AVENUE CORRIDOR DESIGN PROJECT

Past Plans & Studies

- Balboa Park Area Plan, SF Planning, 2009
- Balboa Park Pedestrian and Bicycle Connection Project, SFMTA, 2009
- Balboa Park Capacity Study, 2011

Current Plans & Studies

- Balboa Park Circulation Study, SFCTA
- WalkFirst, SFMTA
- Transit Effectiveness Project, SFMTA
- 15 year plan for the Improvement of the Ocean Avenue Commercial Corridor, Ocean Avenue Association

Projects along Ocean Avenue

- Green Light Rail Center
- Balboa Park Station, Eastside Connection Project
- Ingleside Garden
- Phelan Loop & Public Plaza
- Mobile Parklet
- Invest in Neighborhoods

Green Light Rail Center, SFMTA



Balboa Park Eastside Connection, BART



Phelan Loop and Public Plaza, SFMTA

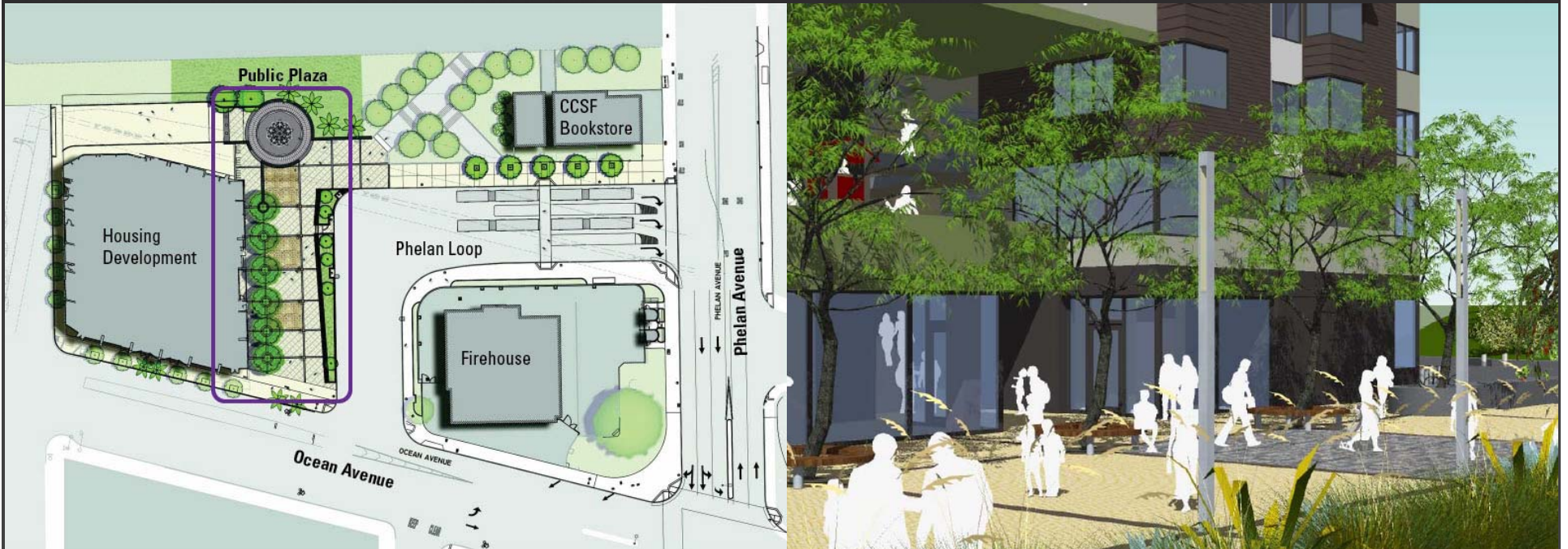

Ingleside Garden

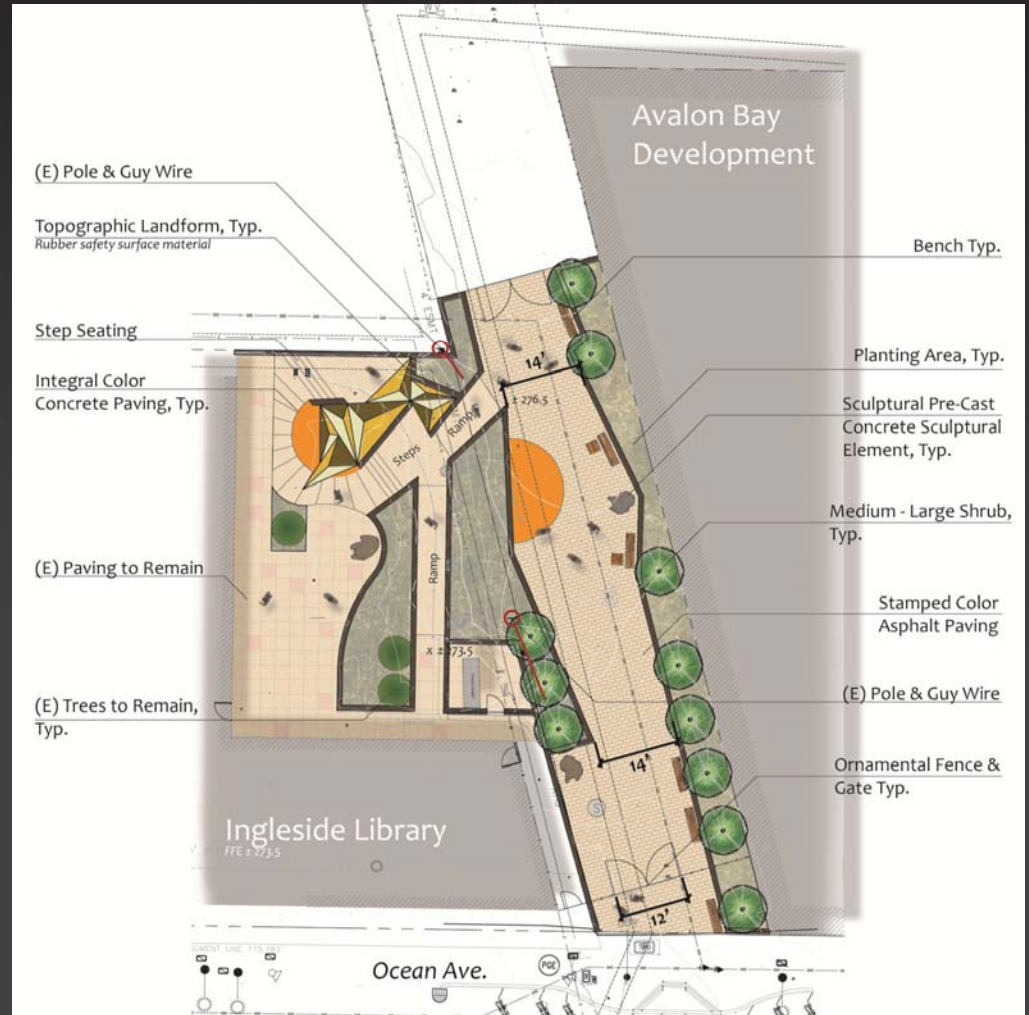

Mobile Parklet, SF Planning



Invest in Neighborhoods, OEWD



OCEAN AVENUE
FROM PHELAN
AVENUE TO
MANOR DRIVE



Small Group Activities Groups – 20 minutes per station

- Three Stations:
 - Overall Likes & Dislikes for the Corridor
 - Near Term Construction Project: Ways to improve and beautify the Commercial Corridor
 - Longer Term Design Project: Your route and experience along Ocean Avenue
- Regroup & Next Steps

Next Steps

- Summarize feedback from tonight's workshop
- Develop design proposals for near term improvements
- Identify topics and areas of study to inform conceptual design
- Ongoing engagement with community members and neighborhood groups
- Next Workshop May 2013

THANK YOU

<http://oceanavenue.sfplanning.org>

SAN FRANCISCO
PLANNING DEPARTMENT

